



**FACTORY DIRECT**

**CME Fabrication, LLC**

**FLAIL-MASTER®**

Your BEST Choice for Quality Mower Parts

816 Esther Lane • Murfreesboro, TN 37129

## MANUFACTURING FLAIL BLADES

Flail Mower Parts



Heavy-Duty Rotary Cutters



**CELEBRATING OVER  
50 YEARS IN BUSINESS!**

**(800) 251-4020 • (615) 848-1813 • [www.flailmaster.com](http://www.flailmaster.com)**



**FLAIL-MASTER®**

**Your BEST Choice for Quality Mower Parts**

Dear Valued Customer,

Thank you for choosing **Flail-Master®** as your supplier for quality replacement parts. As you maintain your mowing equipment throughout the season, remember that for more than 50 years we have provided our customers with quality replacement parts at affordable prices and continue to provide unsurpassed customer service.

**Flail-Master®** is a manufacturer and factory direct company meeting the needs of D.O.T.'s, municipalities, government agencies, universities, hospitals, lawn care professionals, maintenance organizations and individuals across the U.S. We are extremely proud that over **90%** of what we sell is **MADE IN THE USA**, with more than **80%** being produced in our facility **in Tennessee**.



In addition to providing replacement blades and parts, we also have a line of blade sharpeners (grinders), trimmer line, spindles, arborist equipment, and much more to support the efficiency and safety of you and your crew. We welcome suggestions on products you would like to see us carry to better fit your needs as well.

If there is an item you cannot find please contact our Sales Staff at 1-800-251-4020. We have access to thousands of parts not listed in our catalog.

Please take a moment and look through our catalog, or visit our website at [www.flailmaster.com](http://www.flailmaster.com) and see why **Flail-Master®** is:

Sincerely,  
**Flail-Master®**

**Your BEST Choice for Quality Mower Parts**

Flail Mower Replacement Parts • Heavy-Duty Rotary Cutter Parts  
Riding & Walk Behind Mower Parts • Trimmer Parts  
Blade Sharpening Equipment • Mowing Accessories

**Our Mission:**

To provide top quality replacement parts at competitive prices with unsurpassed customer service.

**Our Hours Are:**

Monday thru Friday  
8:00 AM to 4:30 PM (CST)  
*Voicemail available after hours.*

**Contact Us At:**

(800) 251-4020 Toll Free  
(615) 848-1813 Local  
[www.flailmaster.com](http://www.flailmaster.com)

# Flail Mower Replacement Parts

*Flail-Master*<sup>®</sup> has manufactured top quality flail mower parts for more than 50 years. We take pride in making sure all of our parts meet or exceed original equipment manufacturers' (O.E.M.) specifications while offering them to you at a considerable savings. The blades we manufacture are made from high carbon spring steel. This allows them to be heat treated harder, to give longer wear. They are reversible for double life and may be resharpened again and again. All parts are unconditionally guaranteed against defects in material and workmanship. We stock a variety of parts for flail mowers, from blades and mounting hardware to high wear items such as belts, bearings, and pulleys.

*Flail-Master*<sup>®</sup> offers quality replacement parts to fit:

Alamo<sup>®</sup> • Bomford<sup>®</sup> • Bush Hog<sup>®</sup> • Caroni • Diamond<sup>®</sup> • Ford/New Holland<sup>®</sup> • Mott<sup>®</sup> • Servis-Rhino<sup>®</sup>  
Terrain King<sup>®</sup> • Tiger<sup>®</sup> • John Deere<sup>®</sup> • Vrisimo<sup>®</sup> and other popular brands.

## Table of Contents

Contents	Page
Alamo <sup>®</sup> /Mott <sup>®</sup> .....	4
Alamo <sup>®</sup> /Terrain King <sup>®</sup> .....	17
Bomford <sup>®</sup> .....	19
Bush Hog <sup>®</sup> .....	21
Caroni <sup>®</sup> .....	21
Dandl <sup>®</sup> .....	22
Diamond <sup>®</sup> .....	22
Edwards.....	23
Ford.....	23
John Deere.....	25
Tiger <sup>®</sup> .....	26
Vrisimo <sup>®</sup> .....	28

# Heavy-Duty Rotary Cutter Parts

	Page
<u>O.E.M.</u> Style Rotary Cutter Blades.....	29
Mounting Hardware.....	45

# Riding & Walk Behind Mower Parts

	Page
Riding & Walk Behind Blades.....	48

# Mowing Accessories

	Page
Trimmer Line.....	54

**Blades & Mounting Hardware**



**Coarse-Cut**

Blade Requirements		
Mower Model	# of Stations	Blades Required
62	36	72
74	36	72
88	44	88
96	48	96



**M-100759**

**Standard-Duty Blade (02986332)**  
 .106" Thick  
 1 3/4" Wide  
 3" Tall  
 1" x 1/2" Mtg. hole



**FM-7**

**Heavy-Duty Blade**  
 .130" Thick  
 1 3/4" Wide  
 3" Tall  
 1" x 1/2" Mtg. hole



**M-105319M**

**Extreme-Service Blade (02986276)**  
 .192" Thick  
 1 1/2" Wide  
 3" Tall  
 1" x 1/2" Mtg. hole



**M-108381**

**Forged Heavy-Duty Blade**  
 .196" Thick  
 1 3/4" Wide  
 3" Tall  
 1" x 1/2" Mtg. hole



**M-100761**

**Clevis**  
 7/16" Hole  
 1 7/8" Wide (outside)  
 1" Wide (inside ears)  
 2 1/2" Tall



**M-102670**

**Clevis Pin**  
 7/16" x 3"



**MP-26**

**Cotter Pin**  
 1/8" x 7/8"  
 200 per box



**TM-203B**

**Bolt & Nut Set, 7/16" x 3 1/4"**  
 (each set contains 1 bolt & 1 nut)



**Your Part Not Listed?**  
 Call 1-800-251-4020  
 Email us for a custom quote:  
[info@flailmaster.com](mailto:info@flailmaster.com)



**Blades & Mounting Hardware**

**Fine-Cut**

Blade Requirements		
Mower Model	# of Stations	Blades Required
48	60	120
60	76	152
72	92	184
74	92	184
88	108	216
96	118	236



**MH-293**

**Fine-Cut Blade**  
**(101993/02986333)**  
 Ring Mounted  
 .087" Thick  
 1 1/4" Wide  
 2 3/4" Tall  
 3/8" Mtg. hole



**MH-386**

**Fine-Cut Blade**  
**(102086/02988196)**  
 Pin Mounted  
 .087" Thick  
 1 1/4" Wide  
 4.7" Tall  
 5/16" Mtg. hole



**MH-387**

**Renovating Knife**  
 (Pin mounted)  
 OEM# 102087  
 Only 1 per station  
 .087" Thick  
 4.7" Tall, 1 1/4" Wide  
 5/16" Mtg. hole



**MH-291**

**D-Ring**  
 OEM# 101991



**MP-26**

**Cotter Pin**  
 1/8" x 7/8"  
 200 per box



**Optional Ring Clip**

**M-102650**

**Ring Clip**  
 (Flat Bottom)  
 1 3/4" Long



**MH-292**

**Ring Clip**  
 OEM# 101992  
 5/16" x 1 7/8"



**MC-6**

**Clevis Pin**  
 1 1/8" Long  
 OEM# 101034  
 for use with  
 MH-386 & MH-387 Blades



**P-32**

**Bolt**  
 OEM# 000032  
 5/16" x 1 1/4"



**P-210**

**Nut**  
 OEM# 000210  
 for P-32 bolt



**Your Part Not Listed?**  
 Call 1-800-251-4020  
 Email us for a custom quote:  
[info@flailmaster.com](mailto:info@flailmaster.com)

Flail Mower Parts

**Cuttershafts & Components**

**Coarse-Cut**



Part #	Model	Length
M-107123	Model #62 (also replaces M-105719)	66.03"
M-107124	Model #74 (also replaces M-105720)	80.12"
M-107125	Model #88 (also replaces M-105721)	93.25"



**M-100719**  
Coarse-Cut Cuttershaft  
Weld-On Lug

**Fine-Cut**



Part #	Model	Length
M-107127	Model #62 (also replaces M-105723)	66.12"
M-107128	Model #74 (also replaces M-105724)	80.12"
M-107129	Model #88 (also replaces M-105725)	93.25"



**M-101029**  
Weld-On Lug for 60 & 72 (left)

**Bearings & Housings (New Style Cuttershaft)**  
(Models #62,74,88,96)

\* May Need Spacers



**M-704305**  
Cuttershaft Bearing & Housing (Non-Pulley Side)  
Setscrew towards the outside, visible from side of mower



**M-703271**  
Cuttershaft Bearing & Housing (Non-Pulley Side)  
Replaces M-702402, Setscrew toward inside, not visible from side of mower



**M-002530**  
Cuttershaft Bearing only with Setscrew (1 15/16" ID, 3 1/2" OD) used only in M-704305



**M-703695**  
Cuttershaft Bearing & Housing (Pulley Side)  
Replaces M-702403

**M-703694**  
Cuttershaft Bearing only with Setscrew (1 15/16" ID, 3 1/2" OD) used in M-703271 & M-703695  
Replaces M-002315

**Bearings & Housings (Old Style Cuttershaft)**

Ref #	Part #	Description
1	M-102792	Bearing for Models #60, 72 (1 3/16" ID, Press Fit 2.44" OD)
2	M-702408	Bearing & Housing for Models #48, 60, 72 (Grease fitting on bottom, old # M-700736)
3	M-702409	Bearing & Housing for Models #60, 72 (Grease fitting on edge, old # M-700737)
4	M-702409B	Bearing for M-702408 & M-702409 (1 3/16" ID, Self-Aligning 2 7/16" OD)



**Cuttershafts & Components**

Flail Mower Parts

**Pulleys**

Part #	Description
M-103065	Two-Groove Pulley, no brake, 1/4" Keyway
M-500031	Two-Groove Pulley, no brake, 3/8" Keyway
M-500059	Two-Groove Pulley w/brake, 3/8" Keyway
M-701672	Two-Groove Pulley w/brake, 1/4" Keyway
M-02959586	Two-Groove Pulley, no brake, 3/8" Keyway
M-02960512	Two-Groove Pulley, no brake, or setscrew 3/8" Keyway



**Extension Shaft Assembly**

**Extension Shafts**



Part #	Length
M-100159	39 11/16"
M-100286	15 11/16"
M-100287	27 11/16"
M-100288	21 11/16"
M-100724	36 3/16"
M-100778	29 7/16"
M-104685	22 7/16"

**Extension Shaft Housings**



Part #	Length
M-100721	36 1/8"
M-100776	29 9/16"
M-102637	15 5/8"
M-102804	27 5/8"
M-102874	21 5/8"

**Bearing & Housing Assembly**

Part #	Description
M-700491	Bearing & Housing Assembly (all parts below are included)
M-700739	Housing Only
M-000398	Bearing Only (1 1/8" ID, 2 7/16" OD)
M-000402	Snap Ring (2 used)



**Extension Shaft Assembly (cont.)**



**Miscellaneous Drive Parts**

Ref #	Part #	Description
1	M-000520	Lockwasher, 1/2"
2	M-000554	Bolt, 1/2" NF x 1 1/4"
3	M-100010	Bevel Washer
4	M-100057	Snap Ring
5	M-101780	Bearing Lock Washer
6	M-101782	Key
7	M-102651	Pulley Shim (use qty. as needed)
8	M-700171	Splined Coupling

**Belt & Pulley System**

Part #	Description
M-000701	Matched Belt Set for front pumps on Ford Tractors
M-000702	Matched Belt Set for Interstater Wing Mount & Versa Mowers
M-000907	Matched Belt Set for front pumps on Massey Ferguson Tractors
M-000954	Matched Belt Set
M-100706	Belt for Models #50,62,74,88 & 96 Rear Mount
M-102631	Belt for Models #60 & 72 Rear Mount



**NOTE: Extend the life of your new belt by replacing the tension spring. (page 6)**

**M-700488**  
**Belt Guard**  
 with Hardware  
 (for Models  
 #50/#62/#74/#88 & #96)

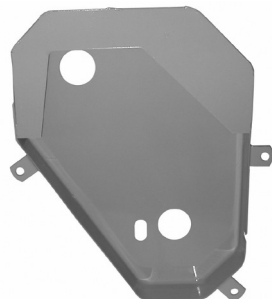



**Belt & Pulley System (cont.)**

Flail Mower Parts

**M-000539**

**Tension Spring**



**M-000547**

**Idler Pulley**  
for Rear Mowers,  
5/8" ID, 6 1/4" OD



**M-000672**

**Pulley Hub**  
for M-000673  
Pulley



**M-000673**

**Two-Groove  
Pulley for  
Wing Mowers**



**M-102501**

**Extension Shaft  
Pulley,**  
for #50/62/74/88/96  
8 1/2" OD, 1 1/8" ID



**M-102565**

**Extension Shaft  
Pulley, 1 1/8" ID**  
for Models #60, 72  
8" OD, 1 1/8" ID



**M-103105**

**Idler Pulley**  
for Wing Mowers  
(2 required),  
5" OD, 5/8" ID



**M-100727**

**Idler Arm for Rear  
Mount Models**  
#50/62/74/88/96

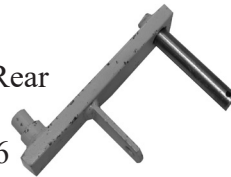

**M-102652**

**Cuttershaft  
Pulley,**  
for Models #62/74/88  
8 3/4" OD, 1 15/16" ID



**M-106528**

**LH Idler Arm**  
(foward rotation  
Interstater left wing)

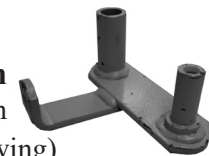

**M-106529**

**RH Idler Arm**  
(foward rotation  
Interstater right wing)

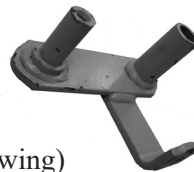

**M-102810**

**Idler Arm**  
Models #60, 72



**M-700949**

**LH Idler Arm**  
w/Grease Fitting  
(foward rotation  
#48 & 60)



**M-700494**

**Idler Arm Assembly**  
for Rear Mount models  
#50/62/74/88/96  
(contains M-000547,  
M-100727 & hardware)



**M-700948**

**RH Idler Arm**  
w/Grease Fitting  
(foward rotation  
Versa #60 & 74)



**M-103041**

**Idler Pivot Pin**  
Used w/ M-700948  
& M-700949



**M-702749**

**Idler Pivot Pin**  
w/Grease Fitting, used  
w/ M-106528 & M-106529



**Your Part Not Listed?**  
Call 1-800-251-4020  
Email us for a custom quote:  
[info@flailmaster.com](mailto:info@flailmaster.com)

**Gearbox & Components**

**Gearboxes (Complete)**

Part #	Description
M-700493	use M-702673 or M-702673A (Replacement parts still available)
M-702673	Comer Brand



**M-700493 Repair Parts**

Ref #	Part #	Description
1	M-000327	Bearing Cup (4 req.)
2	M-000328	Bearing Cone (3 req.)
3	M-000329	Bearing Cone (1 req.)
4	M-100054	Input Shaft Seal (1 req.)
5	M-100055	Output Shaft Seal (1 req.)



**M-702673 & M-702673A Repair Parts**

Ref #	Part #	Description
1	M-001716	Spacer
2	M-001717	Nut
3	M-001718	Pinion
4	M-001719	Seal
5	M-001720	Spring Washer
6	M-001722	Bearing, Roller
7	M-001724	Seal
8	M-001725	Shaft & Gear
9	M-00753222	Shim Kit (contains 4 shims)
10	M-00754459	Bearing, Ball
11	M-00754757	Bearing, Roller
-	M-00754761	Shim



**Gearbox & Components (cont.)**



**M-103713**  
Gearbox Mounting Frame



**M-103715**  
A-Frame Up-Right, LH or RH



**M-102658**  
Overarm, LH or RH



Part #	Description
M-101779	Top Hitch Pin
M-102549	Quick Pin (for 101779)
M-103717	Bushing, Upper

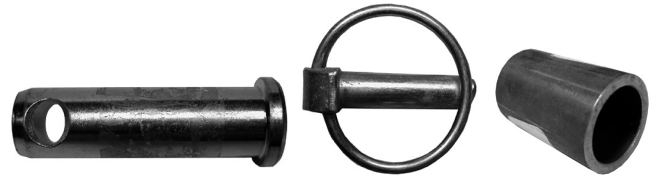

Part #	Description
M-100743	Lower Hitch Pin
M-000333	Click Pin
M-103716	Bushing, Lower

**Front Pump & Tank Parts**  
(New Style Interstater without Blower)

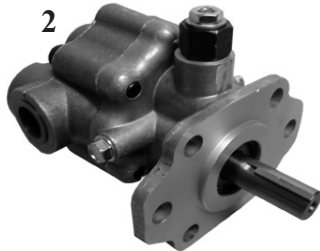

Ref #	Part #	Description
1	M-000810	Oil Temperature Gauge
2	M-000889	Hydraulic Pump used with M-106599 Pulley
3	M-001767	Drive Belt
4	M-106599	Drive Pulley, Upper for M-000889 Hyd. Pump
5	M-02961001	Hydraulic Filter
6	M-02961452	Top Cover O-Ring
7	M-03200350	Filler Cap (Oil Reservoir)

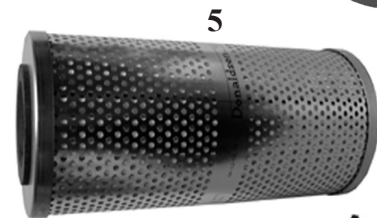

**NOTE: Refer to owner's manual for correct drive shaft.**

**Lift & Tilt Replacement Parts**

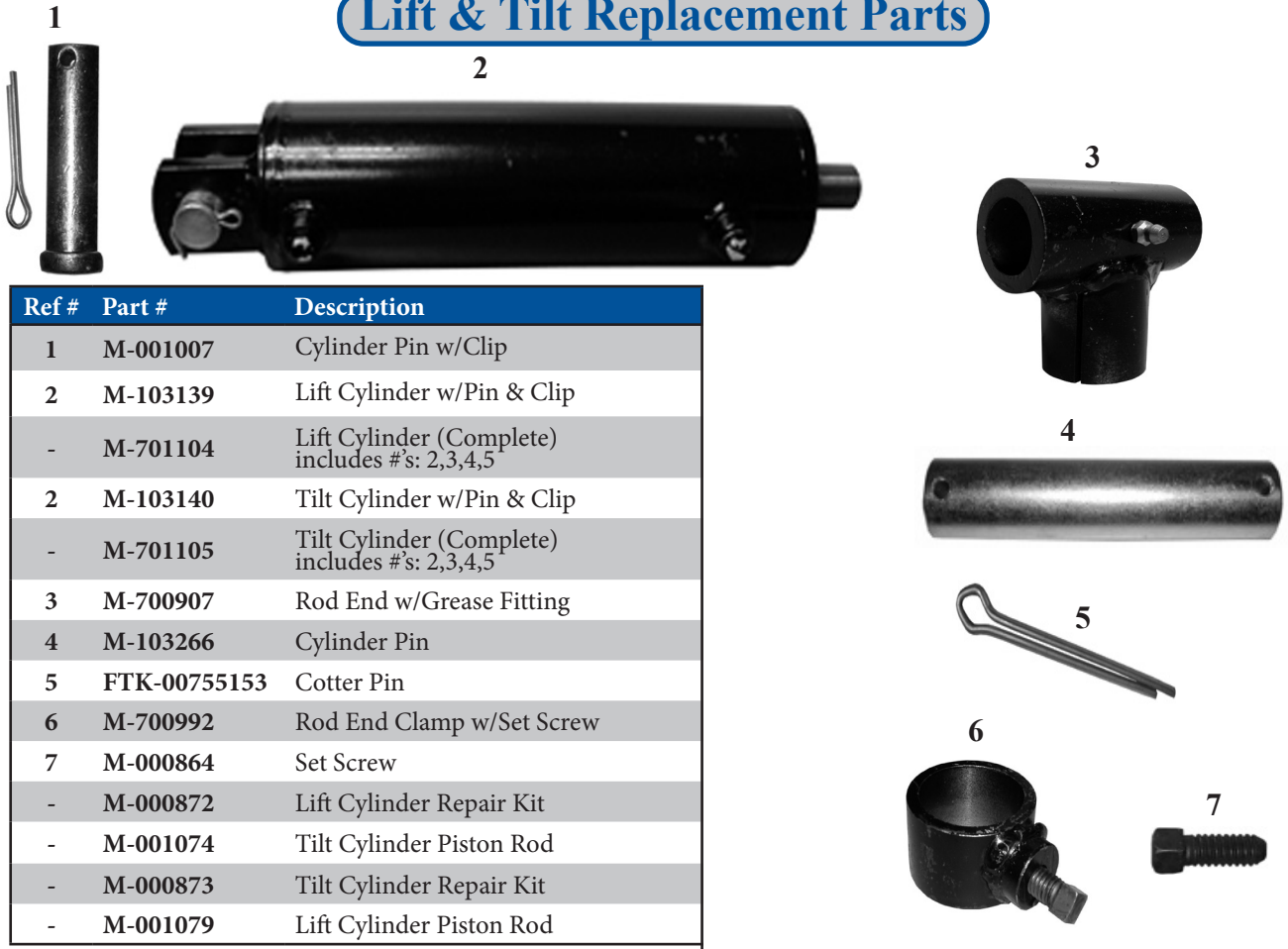

Ref #	Part #	Description
1	M-001007	Cylinder Pin w/Clip
2	M-103139	Lift Cylinder w/Pin & Clip
-	M-701104	Lift Cylinder (Complete) includes #'s: 2,3,4,5
2	M-103140	Tilt Cylinder w/Pin & Clip
-	M-701105	Tilt Cylinder (Complete) includes #'s: 2,3,4,5
3	M-700907	Rod End w/Grease Fitting
4	M-103266	Cylinder Pin
5	FTK-00755153	Cotter Pin
6	M-700992	Rod End Clamp w/Set Screw
7	M-000864	Set Screw
-	M-000872	Lift Cylinder Repair Kit
-	M-001074	Tilt Cylinder Piston Rod
-	M-000873	Tilt Cylinder Repair Kit
-	M-001079	Lift Cylinder Piston Rod

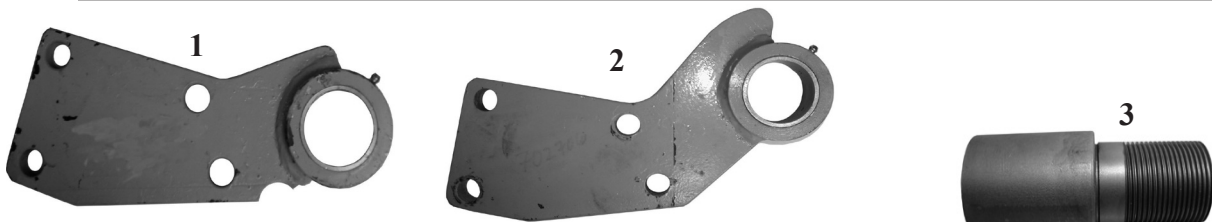

Ref #	Part #	Description
1	M-700972	Pivot Assembly w/Bushing (Old Style Interstater)
2	M-702706	Pivot Assembly w/Bushing (New Style Interstater)
3	M-103062	Pivot Pin
4	M-000760	Nut
5	M-103538	Bushing

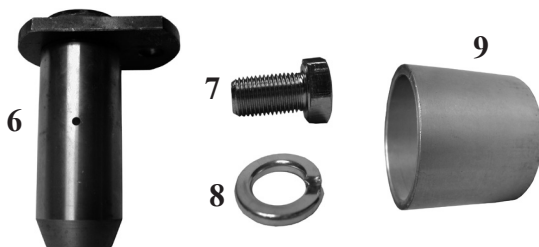

Ref #	Part #	Description
6	M-700883	Inner Pivot w/Fitting
7	M-02035400	Bolt
8	M-03101646	Lockwasher
9	M-104039	Bushing



**PTO Assemblies & Components**

(Series 5)

M-702299 & M-702300

Part #	Description
M-702299	Complete Assembly (includes: M-701408 & M-701410)
M-702300	Complete Assembly w/slip clutch
M-702300SC	Shield Package for M-702300
M-001747W	Splined Clutch Hub (for M-702300)



(Series 6)  
M-001863



**M-001863**  
Series 6 PTO Assembly w/Slip Clutch (Complete)

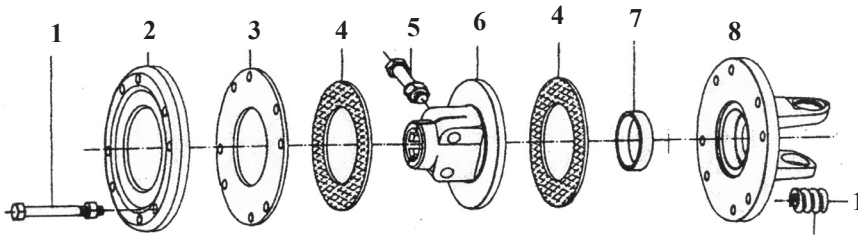

**Replacement Parts for FTK-00769131**

Ref #	Part #	Description
1	M-001499	Spring Kit (includes 8-Bolts; 8-Nuts; 8-Springs)
2	FTK-00769134	Outer Pressure Plate
3	FTK-00769133	Inner Pressure Plate
4	FTK-00769120	Friction Disc
5	FTK-02965273	Bolt
5	FTK-00762372	Nut
5	FTK-00762420	Lockwasher
6	FTK-00769135	Hub
7	FTK-00762528	Spacer (Bushing)
8	FTK-00769137	Flange w/Yoke



**FTK-00769131**  
Slip Clutch Assembly for Series 6 PTO

**Roller Assemblies & Components (cont.)**

**Hex Shaft Roller Assembly**

Flail Mower Parts



Ref #	Part #	Description
1	M-107784	Model #62 Roller (55" from end cap to end cap)
1	M-107785	Model #74 Roller (69 1/16" from end cap to end cap)
1	M-107786	Model #88 Roller (82 3/16" from end cap to end cap)
1	M-107787	Model #96 Roller (90 1/2" from end cap to end cap)
2	M-703976SS	Replacement End Cap, Hex Shaft (for all Hex models) (OEM #107783 w/ an additional 1" of material)
3	M-000516	Carriage Bolt
4	M-00001800	Nut
5	M-002037	Seal
6	M-703976	Bearing & Housing (includes hex bearing, housing & grease fitting)
7	M-002039	Grease Fitting
--	M-002486	Bearing only (hex bore)
8	M-107396	Bracket (Single Row of Mounting Holes)
9	M-02976761	Bracket, LH or RH (Two Rows of Mounting Holes)
--	M-107182	(Replaced by M-02976761)
--	M-107380	(Replaced by M-02976761)
3, 4, 5, 6, 8	M-704027	Bracket & Bearing Assembly (Single Row of Mounting Holes)
3, 4, 5, 6, 9	M-703977	LH Bracket & Bearing Assembly (Two Rows of Mounting Holes)
3, 4, 5, 6, 9	M-703978	RH Bracket & Bearing Assembly (Two Rows of Mounting Holes)
1, 3, 4, 5, 6, 8	M-703599H	Model #62 Roller Assembly (Single Row of Mounting holes on brackets)
1, 3, 4, 5, 6, 9	M-703262H	Model #62 Roller Assembly (Two Rows of Mounting Holes on brackets)
1, 3, 4, 5, 6, 8	M-703600H	Model #74 Roller Assembly (Single Row of Mounting holes on brackets)
1, 3, 4, 5, 6, 9	M-703261H	Model #74 Roller Assembly (Two Rows of Mounting Holes on brackets)
1, 3, 4, 5, 6, 8	M-703601H	Model #88 Roller Assembly (Single Row of Mounting holes on brackets)
1, 3, 4, 5, 6, 9	M-703260H	Model #88 Roller Assembly (Two Rows of Mounting Holes on brackets)

**Roller Assemblies & Components**

**Round Shaft Roller Assembly**

Flail Mower Parts

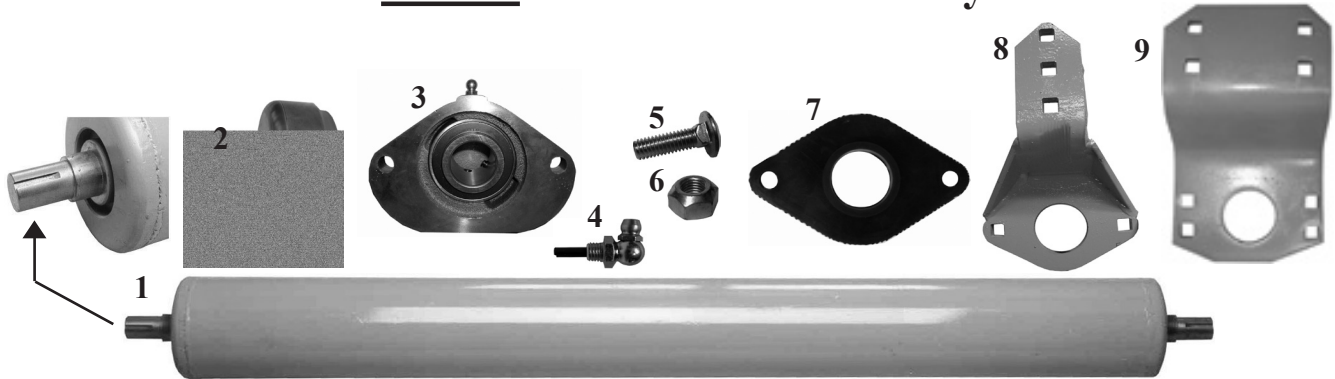

Ref #	Part #	Description
1	M-107176	Model #62 Roller , 55" (Obsolete -NLA)
1	M-107177	Model #74 Roller , 69 1/16" (Obsolete -NLA)
1	M-107178	Model #88 Roller , 82 3/16" (Obsolete -NLA)

**Reference Hex Shaft Roller Assembly For Replacement Parts**

**Threaded Shaft Roller**

Threaded rollers are no longer available. Use the following chart to find correct conversion kit.

OEM Part #	Description	Use
105701	#62 Roller	M-703599H
701646	#62 Roller Assembly	
105702	#74 Roller	M-703600H
701401	#74 Roller Assembly	
105703	#88 Roller	M-703601H
701402	#88 Roller Assembly	



**M-702485**  
Bearing & Housing  
w/set screws & grease fitting

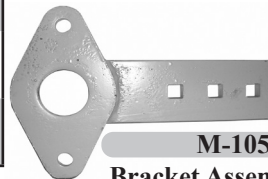

**M-105697**  
Bracket Assembly

Part #	Description
M-000142	Capscrew
M-000170	Nut
M-000520	Lockwasher
M-001096	Roller Nut
M-106913	Spacer

**Miscellaneous Roller Parts (Old Style Rollers)**



**M-102002**  
Roller Bearing (#701907)  
mounts inside roller shell  
on old style rollers w/tie rod  
for Models #60 & #72  
3/4" Inside Diameter



**M-001092**  
Roller Bearing (#701906)  
mounts inside roller shell  
on old style rollers w/tie rod  
for Models #74 & #88  
1 3/8" Inside Diameter

**Front Foot Guards**

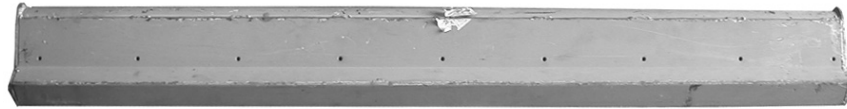

Part #	Model	Length
M-107254	#62 Rear Mount SHD/Interstater	62"
M-107256	#74 Rear Mount SHD/Interstater	76 5/8"
M-107257	#74 Wing Mount Interstater	76 3/4"
M-107258	#88 Rear Mount SHD/Interstater	89"
M-107259	#88 Wing Mount Interstater	89 3/4"
M-106330	#88 Rear Mount Interstater (Old Style)	89 3/4"

**NOTE:** Below are the different style ends for each foot guard. Please, pay careful attention to your style before ordering.



M-107254



M-107256



M-107257



M-107258



M-107259



M-106330

**Trash Deflectors**

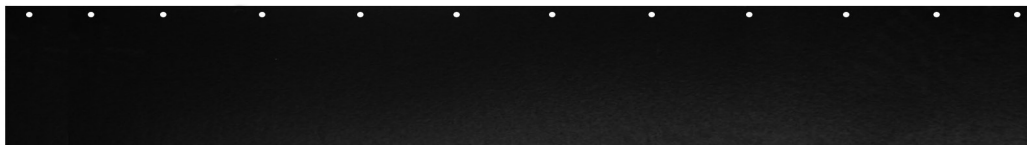

Part #	Description	Length	Thickness	# of Bolt Holes
M-104682	Deflector only for Model #62	63 1/2"	3/16"	9
M-701650	Package for Model #62 (includes deflector & mounting hardware)	63 1/2"	3/16"	9
M-100783	Use M-700524 Kit	---	---	---
M-700524	Package for Model #74 *3/16" thick x 6" tall (includes deflector & mounting hardware)	76 3/4"	3/16"	11
M-100755	Use M-700498 Kit	---	---	---
M-700498	Package for Model #88 *3/16" thick x 6" tall (includes deflector & mounting hardware)	90"	3/16"	12

\*New style 3/8" thick x 8" tall available at additional cost, please call for details.



Miscellaneous Replacement Parts

Flail Mower Parts

Ref #	Part #	Description
-	M-000201	Seal
1	M-000225	Bearing Cone
2	M-000226	Bearing Cup
3	M-000759	Hydraulic Swivel Joint
-	M-000961	Counter Bore Screw
4	M-001083	Mercury Tilt Switch
5	M-001159	Solenoid Valve Assembly (for M-701500)
-	M-001160	Coil Only, 2-Prong (part of M-001159)
6	M-002502	Solenoid Valve Assembly (new Interstaters & SHD)
7	M-002503	Coil Only, 3-Prong (part of M-002502)
-	M-002504	Solenoid Coil Connector



Alamo® / Terrain King®

Flail Axe Replacement Parts

FTK-02956707

Flail Axe Blade



FTK-02958540

Balanced Set of 16 Blades



FTK-02956943

Bushing



FTK-02956948

Nut



FTK-02956949

Hanger Bolt



FTK-02958131  
Cuttershaft Bearing & Flange

FTK-02958176  
Bearing Insert for FTK-02958131

Miscellaneous Flail Axe Parts

Part #	Description
FTK-00001200	Nut
FTK-00001300	Lockwasher
FTK-02892000	Bolt
FTK-02956712	Trash Deflector
FTK-02956714	Clamp Bar
FTK-02957041	Roller Bearing & Flange
FTK-02958198	Key
FTK-02959835	Cuttershaft Pulley
FTK-02970539	V-Belt
M-000533	Belt

**Heavy-Duty Boom Mounted & Versa**

**Blades & Mounting Hardware**

**M-100759**

**Standard-Duty Blade**

.106" Thick  
1 3/4" Wide  
3" Tall  
1" x 1/2" Mtg. hole



**FM-7**

**Heavy-Duty Blade**

.130" Thick  
1 3/4" Wide  
3" Tall  
1" x 1/2" Mtg. hole



**FTK-02958063**

**Extreme-Service Blade**

.192" Thick  
1 1/2" Wide  
3" Tall  
1" x 1/2" Mtg. hole



**M-108381**

**Forged Heavy-Duty Blade**

.196" Thick  
1 3/4" Wide  
3" Tall  
1" x 1/2" Mtg. hole



**M-100761**

**Clevis**

7/16" Hole  
1 7/8" Wide (outside)  
1" Wide (inside ears)  
2 1/2" Tall



**M-102670**

**Clevis Pin**

7/16" x 3"



**MP-26**

**Cotter Pin**

1/8" x 7/8"  
200 per box



**Miscellaneous Replacement Parts**

**M-700886**

**Shoe Wear Plate w/Bolts and Nuts**

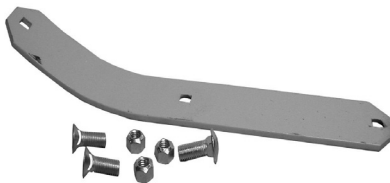

**M-103051**

**Shoe Wear Plate (Only) w/o Bolts and Nuts**



**M-500059**

**Cuttershaft Pulley**

2-Groove w/Brake  
3/8" Keyway



Part #	Description
FTK-02957167	Bearing
FTK-02957169	Seal
FTK-02957173	Seal, Cuttershaft
M-701650	Trash Deflector Package, Model #62

**Extension Arm Assembly**



**FTK-02880100.....\$49.59 ea**  
Cable Assembly

Part #	Description
FTK-02959438	Pin, Attach (Versa Flail only)
FTK-02957536	Pin
FTK-02930200	Pin
FTK-10318000	Bolt
M-00001800	Nut, (1/2"-13 locknut)

**Miscellaneous Replacement Parts**



**M-02961001**  
Hydraulic Filter  
(Replaces M-02961002)



**M-500031**  
Cuttershaft Pulley  
No Brake  
3/8" Keyway



**M-702485**  
Roller Bearing  
& Housing

**Not Able to Find Your Part?**  
Call 1-800-251-4020. We have access to thousands of parts not listed in our catalog.

**Bomford®**

**FMB-0281201**

**Blade**  
.192" Thick, 3" Tall  
1 1/2" Wide  
1.24" x .62" Mtg. hole  
**\*Cannot be mixed with O.E.M. blades.**



**FMB-0952801**

**Forged Blade**  
for Machete/Grass Head  
.301" Thick, 4" Tall  
1 1/2" Wide  
1.4" x .58" Mtg. hole



**FMB-0951701**

**Shackle**  
0.61" Hole  
1.94" Wide (outside)  
0.9" Wide (inside ears)  
2.6" Tall



**FMB-0589501**

**Shackle**

0.61" Hole  
1.8" Wide (outside)  
1.1" Wide (inside ears)  
2.35" Tall



**FMB-0295901**

**Single Piece Blade**

1 1/2" Wide



**FMB-0990201**

**Single Piece Blade**

2 1/4" Wide



**FMB-0280101**

**Collar** for 10mm lugs, 1/8" lip, 10mm ID, used with FMB-0589501 Shackle



**FMB-0280103**

**Collar** for 6mm lugs, 1/4" lip, 10mm ID, used with FMB-0589501 Shackle



**FMB-0280701**

**Spacer** for 6mm & 10mm lugs, 1" OD, 1" long



**FMB-0577502**

**Bolt**

M10-1.25 x 85mm



**FMB-0528202**

**Washer**

for use with FMB-0577502 Bolt



**FMB-0596802**

**Self-Locking Nut**

10mm, for use with FMB-0577502 Bolt

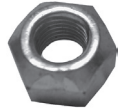

**FMB-0367525**

**Bolt, Nut & Washer Pack**  
**10mm x 85mm**

10 of each per pack,  
0577502/0596802/0528202



**FMB-4259403**

**Flail-Axe Blade** w/Mounting Ears, (same as 4640201) 25mm mtg. hole



**FMB-4259401**

**Flail-Axe Blade** w/Solid Mounting, 25mm mtg. hole



**FMB-0367526**

**Bolt & Nut Pack**  
**1/2" x 4 7/8", Grade 8**  
10 of each per pack,  
0529504/0541101 for use with FMB-4259802 collars



**FMB-4259802**

**Collar** for 1/2" Bolt (Bolt #0529504 or bolt pack #0367526)



**FMB-0596806**

**Self-Locking Nut** 14mm, for use with FMB-0577513 Bolt



**FMB-4116701**

**Bolt, Nut & Washer Pack, 14mm x 96mm**  
10 of each per pack,  
0577510/0596806/058208 for use with FMB-4259801 collars



**FMB-4259801**

**Collar** for 14mm Bolt (Bolt #0577513)



**FMB-0577513**

**Bolt**, 14mm x 140mm, used w/ 0596806 nut & 0596806 washer, and 4259801 collar



**NOTE: Other Bomford parts available. Call 1-800-251-4020 for prices and availability.**





1 1/2" Wide  
4.95" Tall  
.192" Thick  
9/16" Hole

**Models**  
FM36  
FM48  
FM60  
FM72  
FH48  
FH60  
FH72  
FH90

**FBH-68100 Standard Blade**

**FBH-68033 Nut**

**FBH-68035 Keep Plate**

**FBH-68036 Screw**

**FBH-68039 Spacer (2 required)**

**Models FH174 & FH188**



1 3/4" Wide  
3" Tall  
.130" Thick  
1" x 1/2" Mtg. hole

**FM-7 Heavy-Duty Blade**

**FM-222207 Thatching Blade (Straight)**

**FM-222157 Link**

**FM-7502617 Hanger**

**750-CB Carriage Bolt**

**750-LN Lock Nut**

.192" Thick  
1 1/2" Wide  
3" Tall  
1" x 1/2" Mtg. hole



**C-30838 Flail Blade**

**C-30839 Clevis / Shackle**



1 1/2" Wide  
4.95" Tall  
.192" Thick  
.450" Hole

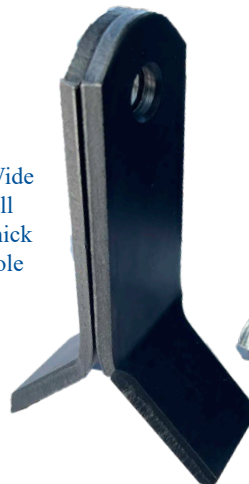

**C-05001200 Long Flail Blade**

**C-09000010 Bolt**

**C-01010045 Nut**



1 3/4" Wide  
3" Tall  
.130" Thick  
1" x 1/2" Mtg. hole



**DFM-IA2016 Standard Blade**



2.7" Tall  
2.8 Cutting width  
1/2" x 1" Mtg. hole

**DFM-2042 Single-Piece Blade**

**DFM-I4132 Clevis**

**DFM-I4133 Cotter Pin (200/Box)**

**DFM-I4134 Clevis Pin**

**TM-203B Bolt & Nut Set**



**Diamond®**



**DM-22-1001**

**Heavy Duty Blade**

.192" Thick  
1 1/2" Wide  
3" Tall  
1" x 1/2" Mtg. hole

**DM-22-1006**

**Single-Piece Blade**

OEM #TF1019F  
2.78" Cutting width  
3" Tall  
1/2" x 1" mtg. hole



**DM-11-1501**

**Clevis**

7/16" Hole  
1 7/8" Wide (outside)  
1" Wide (inside ears)  
2 1/2" Tall

**DM-22-1003**

**Blade**

OEM #TF1019  
.145" Thick  
1 3/4" Wide  
4" Tall  
1/2" x 1" mtg. hole



**TM-203B**

**Bolt & Nut**

Set, 7/16"  
x 3 1/4"  
(each set contains  
1 bolt & 1 nut)



**Virtually all Diamond® replacement parts available,  
call for prices and availability.**

# Edwards

Your BEST Choice for Quality Mower Parts

Flail Mower Parts



**EM-217-1 Heavy-Duty Blade (.25" Thick)**  
1.8" Wide, 3.6 Tall, .25" Thick,  
1.2" x .58" Mtg. hole

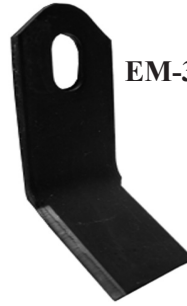

**EM-301 Standard Blade (.15" Thick)**  
1.75" Wide, 3.8 Tall, .15 Thick  
1" x 1/2" Mtg. hole



**EM-815 Ring**

**EM-9041 Pin**



# Ford

## Blades & Mounting Hardware

### Model #917 Fine-Cut

Blade Requirements		
Mower Size	# of Stations	Blades Required
5 foot	81	162
6 foot	99	198
7 foot	117	234



**FM-7501732 Fine-Cut Blade**

**FM-7501730 Link (NLA)**

**FM-7502618 Hanger (NLA)**

**750-CB Carriage Bolt**

**750-LN Lock Nut**

1 1/4" Wide  
3 1/2" Tall  
.085 Thick  
.34" x .68" Mtg. hole

### Model #907 #917 Coarse-Cut

Blade Requirements		
Mower Size	# of Stations	Blades Required
5 foot	27	54
6 foot	33	66
7 foot	39	78

**FM-220336**  
907 Link



**FM-7 Heavy-Duty Blade**  
1 3/4" Wide, 3" Tall,  
.130" Thick, 1" x 1/2" Mtg. hole

**FM-222157 Link** (also used on Model 907)

**FM-7502617 Hanger**

**750-CB Carriage Bolt**

**750-LN Lock Nut**

**FM-220398**

**Single-Piece Blade**  
2.6" Cutting width,  
3" Tall,  
1" x 1/2" Mtg. hole



**FM-222207**

**Thatching Blade**  
1 1/2" Wide, 3" Tall,  
.192" Thick, 1" x 1/2" Mtg. hole



**Belts and Bearings Available**  
Please Call 1-800-251-4020

**Blades & Mounting Hardware (cont.)**

**Model #918H**

Blade Requirements		
Mower Size	# of Stations	Blades Required
62"	40	80
74"	48	96
88"	64	128



1 1/2" Wide  
4.6" Tall  
.192" Thick  
9/16" Hole

**FM-6200080 Standard Blade**

**FM-0000149 Bolt**

**FM-0000219 Locknut**

**FM-6200071 Locking Plate**

**FM-6200072 Spacer (2\* required for models 62" & 74")**

\*Use two simple 1/8" thick washers for 88" units\*

**Model #918L**

Blade Requirements		
Mower Size	# of Stations	Blades Required
50"	40	80
60"	48	96



1 1/8" Wide  
4.7" Tall  
1/8" Thick  
7/16" Hole

**FM-6101080 Blade**

**Miscellaneous Parts for Model #917**

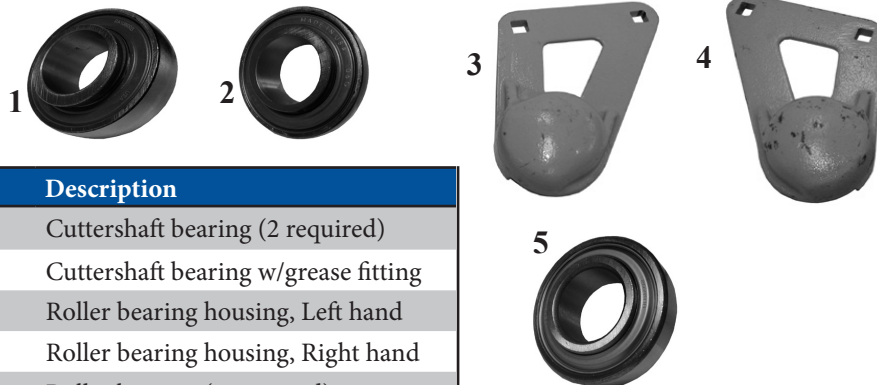

Ref #	Part #	Description
1	FM-241565	Cuttershaft bearing (2 required)
2	FM-241565G	Cuttershaft bearing w/grease fitting
3	FM-7501256	Roller bearing housing, Left hand
4	FM-7501257	Roller bearing housing, Right hand
5	FM-7501260	Roller bearing (2 required)
6	FM-7501852	Belt
*Some Products Now Obsolete		

Here at FlailMaster we strive to keep out customers informed when parts start to become obsolete  
**We Want to Keep You Mowing!**

**300 Series**

Blade Requirements		
Model	# of Stations	Blades Required
360 Smooth-Cut	27	27
360 Heavy-Duty	27	54
370 Smooth-Cut	33	33
370 Heavy-Duty	33	66
390 Smooth-Cut	42	42
390 Heavy-Duty	42	84



1.9" Wide  
3" Tall  
.265" Thick  
3/4" Hole

JD-P57928 Heavy-Duty Knife

JD-P57925 Ring

JD-P57926 Clip

JD-19H1777 Cap Screw

JD-19H1777N Nut

**JD-31900**

**Smooth-Cut Blade**, 2.8" Tall  
2.9" Cutting width  
1/2" x 3/4" Mtg. hole



**Miscellaneous Parts for 300 Series**

Part #	Description
JD-E14377	Cuttershaft Bearing Housing (bearing not included)
JD-9275	Cuttershaft Bearing
JD-E51728	Belt

**Model 25A**

Blade Requirements		
Model	# of Stations	Blades Required
Smooth-Cut	36	36
Heavy-Duty	36	72



1 3/4" Wide  
3" Tall  
.130" Thick  
1/2" x 1" Hole

FM-7 Heavy-Duty Blade

JD-31903 Link (Ring)

JD-31905 Hanger

JD-19H1801 Capscrew, 3/8"

750-LN Lock Nut

**JD-31900**

**Smooth-Cut Blade**, 2.8" Tall  
2.9" Cutting width  
1/2" x 3/4" Mtg. hole



**Miscellaneous Parts for Model 25A**

Part #	Description
JD-9275	Cuttershaft Bearing
MAE-20715	Cuttershaft Bearing & Housing
MAE-29309	Roller Bearing & Housing (Hex bore-replaces MAE-30587)
M-100706	Belt



**Blades & Mounting Hardware**

Flail Mower Parts

**TM-201**

**Blade**

OEM #TF1019  
 .145" Thick  
 1 3/4" Wide  
 4" Tall  
 1/2" x 1" mtg. hole



**TM-201F**

**Single-Piece Blade**

OEM #TF1019F  
 2.78" Cutting width  
 3" Tall  
 1/2" x 1" mtg. hole



**TM-201S**

**Super-Tuf Brand**

(sharpened full length of blade), .145" Thick  
 1 3/4" Wide  
 4" Tall  
 1/2" x 1" mtg. hole



**TM-201T**

**Thatching Blade**

OEM #TF1019T  
 .145" Thick  
 1 3/4" Wide  
 4" Tall  
 1/2" x 1" Mtg. hole



**TM-28054**

**Standard-Duty Blade**

.106" Thick  
 1 3/4" Wide  
 3" Tall  
 1/2" x 1" Mtg. hole



**TM-33713**

**Forged Flail Blade**

replaces TM-28054  
 .196" Thick  
 1 3/4" Wide  
 3" Tall  
 1/2" x 1" Mtg. hole



**TM-33714**

**Forged Flail Blade**

replaces OEM #TF1019  
 3/16" Thick  
 1 3/4" Wide  
 4" Tall  
 .57" x 1.3" Mtg. hole



**TM-202**

**Clevis**

OEM #TF1020  
 7/16" Hole  
 1 7/8" Wide (outside)  
 1" Wide (inside ears)  
 2 1/2" Tall



**TM-203**

**Clevis Pin**

OEM #TF1021  
 7/16" Wide  
 3" Long



**MP-26**

**Cotter Pin**

1/8" x 7/8"  
 200 per box



**TM-203B**

**Bolt & Nut Set**

OEM #34011 & 21677

(set = 1 bolt & 1 nut)



**Part Numbers are for Identification Purposes Only**

### Roller Replacement Parts



**TM-1022S**  
Roller Shaft  
Bearing & Housing  
(Extra Heavy-Duty)



**TM-1022**  
Roller Shaft  
Bearing & Housing



**TM-1045**  
Stub Shaft for  
Ground Roller



**TM-4333A**  
Ground Roller  
Adjustment Bracket



**TM-1041**  
Dust Cap (Metal)  
for old style brg/hsg  
TM-1022

### Miscellaneous Replacement Parts

Part #	Description
TM-0102	Sheave
TM-1018	Cuttershaft Bearing & Housing (2 3/16" bore)
TM-28683	Cuttershaft Bearing & Housing (1 15/16" bore)
TM-3020	Belt (for side mount hyd. driven)
TM-3021	Belt (for rear mount PTO driven, 40", 2 required)
TM-3023	Belt (for rear mount PTO driven, 63", 2 required)
TM-3040	Sheave
TM-3609	Bushing with Bearing
TM-6T0110	Cable 1/2" x 7' 3-3/4"
TM-6T0110E	Cable 1/2" x 7' 9-3/4"
TM-6T0104N	Sheave Pin Bushing (for TM-0102 Sheave)
TM-6T1029	Chain for Coupler
TM-6T1030	Sprocket (1 1/8" bore)
TM-6T1031	Sprocket (1 1/2" bore)
TM-6T1033	Coupling Cover Assembly
TM-6T3009	Lower Sheave Pin
TM-6T3010	Upper Sheave Pin
TM-6T3020	Sheave Pin Clip



**TM-27528**  
Skid Shoe, Right Side

**TM-27529**  
Skid Shoe, Left Side

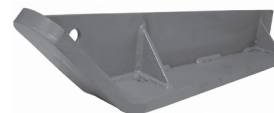

**TM-4365**  
Inner Shoe Wear  
Plate

**TM-4371**  
Outer Shoe Wear Plate



Virtually all Tiger® replacement parts available, call for prices and availability.

## Blades

**V-CD2100**

**Industrial Knife**

3.3" Tall  
2" Wide  
.174" Thick  
1/2" x 1" Mtg. hole



**V-CD2110**

**Scoop Knife**

2.8" Tall  
2.85" Cutting width  
1/2" x 3/4" Mtg. hole



## Mounting Hardware

**V-CD2120**

**Hanger**



**V-CD2135**

**D-Ring**



**We stock parts not listed in our catalog**

**Call 1-800-251-4020 for pricing and availability,**

**or email us for a custom quote:**

**[info@flailmaster.com](mailto:info@flailmaster.com)**

**\*All Part Numbers are for identification purposes**

**O.E.M. Style Blades**

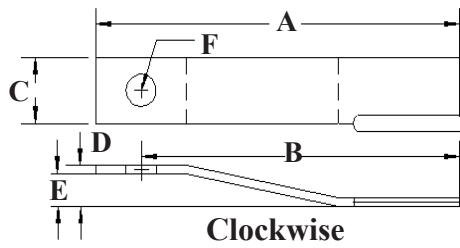

Overall Length: **A**  
 Working Length: **B**  
 Width: **C**  
 Thickness: **D**  
 Offset: **E**  
 Hole Size: **F**

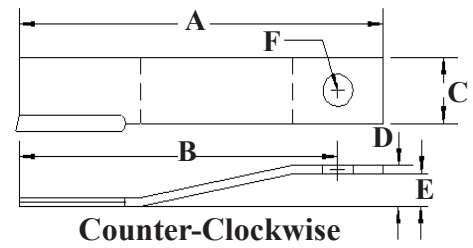

**Part Number**

**FTK-00127028**

**Fits Models:** SMC, Mowal,  
 A-Boom 28', Hydro 15, Versa  
 Boom 28', TK530 A-Boom

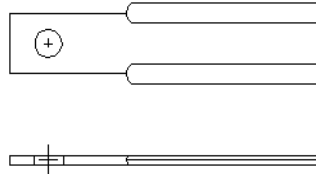

**Non-Directional**

Overall Length: **14"**  
 Working Length: **11 1/2"**  
 Width: **3"**  
 Thickness: **1/2"**  
 Offset: **none**  
 Hole Size: **1 1/4"**  
 Weight: **6 lbs.**

**Part Number**

**FTK-00750787T**

**Fits Models:** TK15, TK15HD, X5,  
 AG15IV, DB60, Versa 72",  
 Hydro 15 (right wing)  
**(OEM sells as set of 2 #00752971)**

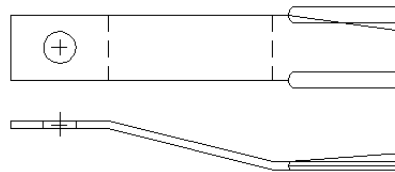

**Clockwise**

Overall Length: **24 3/4"**  
 Working Length: **22 1/4"**  
 Width: **3 1/2"**  
 Thickness: **1/2"**  
 Offset: **3"**  
 Hole Size: **1 1/2"**  
 Weight: **11.5 lbs.**

**Part Number**

**FTK-00750788T**

**Fits Models:** TK15, TK15HD, X5,  
 AG15IV, AG60/72, MD60/72,  
 Hydro 15 (left wing & center)  
**(OEM sells as set of 2 #00752972)**

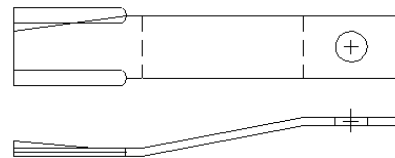

**Counter-Clockwise**

Overall Length: **24 3/4"**  
 Working Length: **22 1/4"**  
 Width: **3 1/2"**  
 Thickness: **1/2"**  
 Offset: **3"**  
 Hole Size: **1 1/2"**  
 Weight: **11.5 lbs.**

**Part Number**

**FTK-00753841**

**Fits Models:** Alamo 100 Semi-Mount,  
 TK100, 101(HD), 120, AG96

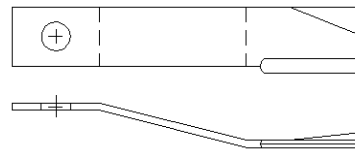

**Clockwise**

Overall Length: **20"**  
 Working Length: **17 1/2"**  
 Width: **3 1/2"**  
 Thickness: **1/2"**  
 Offset: **2"**  
 Hole Size: **1 1/2"**  
 Weight: **9.4 lbs.**

**Part Number**

**FTK-00753842**

**Fits Models:** Alamo 100 Semi-Mount,  
 TK100, 101(HD), 120, AG96

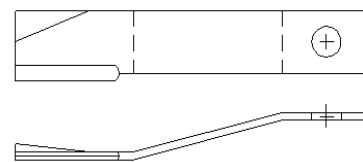

**Counter-Clockwise**

Overall Length: **20"**  
 Working Length: **17 3/4"**  
 Width: **3 1/2"**  
 Thickness: **1/2"**  
 Offset: **2"**  
 Hole Size: **1 1/2"**  
 Weight: **9.4 lbs.**

**Blade bolts and related mounting hardware can be found on pages 45-47.**

Hvy.-Duty Rotary Cutter Parts

## O.E.M. Style Blades

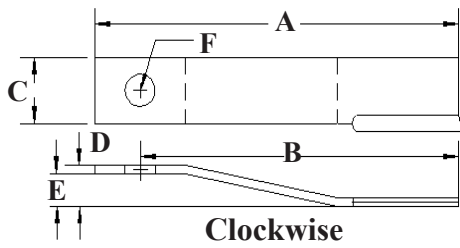

Overall Length: **A**  
 Working Length: **B**  
 Width: **C**  
 Thickness: **D**  
 Offset: **E**  
 Hole Size: **F**

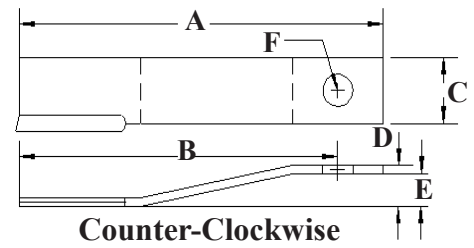

Hvy.-Duty Rotary Cutter Parts

**Part Number**

**FTK-02726900**

**Fits Models:** Boom Axe models, Machete Boom, Slopemower, Versa Boom 60", A-Boom 60"  
 (OEM sells as set of 2 #02761500)

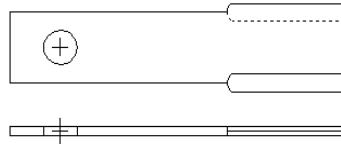

**Non-Directional**

Overall Length: **14 1/2"**  
 Working Length: **12"**  
 Width: **5"**  
 Thickness: **5/8"**  
 Offset: **none**  
 Hole Size: **1 1/2"**  
 Weight: **12 lbs.**

**Part Number**

**FTK-02761500**

**Fits Models:** A-Boom, Boom-Axe, Double Swing, Machete, Minute Man, Rear Mount Boom, Slopemower, Versa  
 (Set of 2 Blades w/Roll Pins)

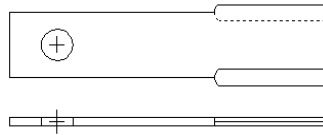

**Non-Directional**

Overall Length: **14 1/2"**  
 Working Length: **12"**  
 Width: **5"**  
 Thickness: **5/8"**  
 Offset: **none**  
 Hole Size: **1 1/2"**  
 Weight: **12 lbs.**

**Part Number**

**FTK-02886200**

**Fits Models:** Grass King, Hydro, Versa 60" & 72"  
 (OEM sells as set of 2-#02977557)

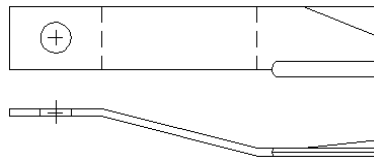

**Clockwise**

Overall Length: **20 1/4"**  
 Working Length: **17 5/8"**  
 Width: **4"**  
 Thickness: **1/2"**  
 Offset: **2 1/4"**  
 Hole Size: **1 1/2"**  
 Weight: **11 lbs.**

**Part Number**

**FTK-02962635**

**Fits Models:** Boom Axe models A-Boom 50", Versa Boom 50"  
 (OEM set of 2 w/roll pins #02962634)  
 (OEM set of 3 w/roll pins #02962722)

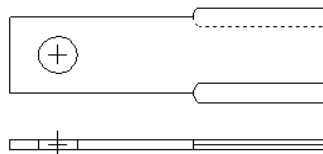

**Non-Directional**

Overall Length: **13 5/8"**  
 Working Length: **11"**  
 Width: **5"**  
 Thickness: **5/8"**  
 Offset: **none**  
 Hole Size: **1 1/2"**  
 Weight: **11 lbs.**

**Part Number**

**FTK-02964824**

**Fits Models:** A-Boom, Brahma, Grass King, Versa 60"  
 (OEM sells as set of 3 #02964960)

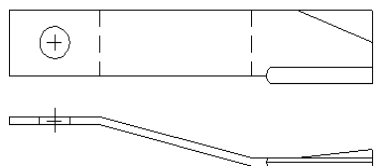

**Clockwise**

Overall Length: **18 1/2"**  
 Working Length: **16"**  
 Width: **4"**  
 Thickness: **1/2"**  
 Offset: **2"**  
 Hole Size: **1 1/2"**  
 Weight: **10.8 lbs.**

Blade bolts and related mounting hardware can be found on pages 45-47.



**O.E.M. Style Blades**

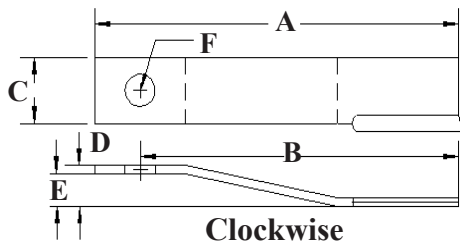

Overall Length: **A**  
 Working Length: **B**  
 Width: **C**  
 Thickness: **D**  
 Offset: **E**  
 Hole Size: **F**

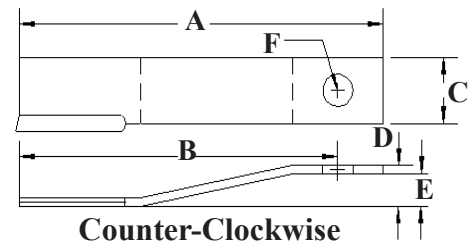

**Counter-Clockwise**

**Part Number**

**FTK-8588**

**Fits Models:** A315/A415 Flex Wing, AG72-B, A72, Superflex 15III/15HD/15  
**(Set of 2 Blades)**

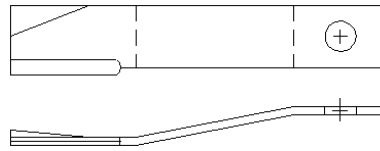

**Counter-Clockwise**

Overall Length: **26 3/8"**  
 Working Length: **25"**  
 Width: **4"**  
 Thickness: **1/2"**  
 Offset: **2"**  
 Hole Size: **1 1/2"**  
 Weight: **14.4 lbs.**

**Part Number**

**FTK-8589**

**Fits Models:** A315/A415 Flex Wing, AG60-B, AG-60, TW120, Superflex 15III/15HD/15  
**(Set of 2 Blades)**

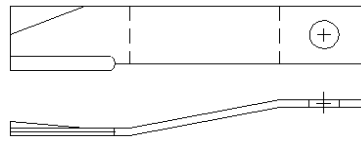

**Counter-Clockwise**

Overall Length: **20 1/8"**  
 Working Length: **18"**  
 Width: **4"**  
 Thickness: **1/2"**  
 Offset: **2"**  
 Hole Size: **1 1/2"**  
 Weight: **11 lbs.**

**Part Number**

**FTK-8590**

**Fits Models:** A315/A415 Flex Wing, Exten-A-Kut II, SE15, TW120, Superflex 15III/15HD/15  
**(Set of 2 Blades)**

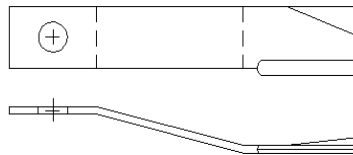

**Clockwise**

Overall Length: **20 1/8"**  
 Working Length: **18"**  
 Width: **4"**  
 Thickness: **1/2"**  
 Offset: **2 1/8"**  
 Hole Size: **1 1/2"**  
 Weight: **11 lbs.**

Hyv.-Duty Rotary Cutter Parts

**We stock parts not listed in our catalog**

**Call 1-800-251-4020 for pricing and availability,**

**or email us for a custom quote:**

**[info@flailmaster.com](mailto:info@flailmaster.com)**

*\*All Part Numbers are for identification purposes*

**Blade bolts and related mounting hardware can be found on pages 45-47.**

**O.E.M. Style Blades**

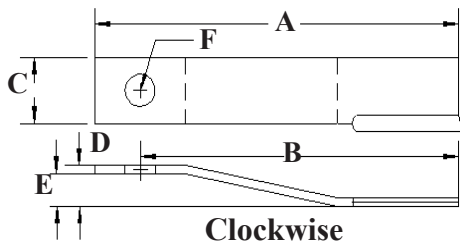

Overall Length: **A**  
 Working Length: **B**  
 Width: **C**  
 Thickness: **D**  
 Offset: **E**  
 Hole Size: **F**

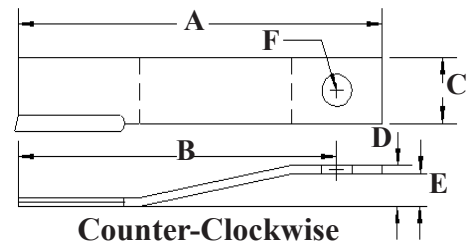

**Counter-Clockwise**

**Part Number**

**BH-11150**

**Fits Models:** 126 right side, 315 left side, 1126 right side, 1226 right side, 1315 left side, 2315 left side, 2615 left side, 2415 left side, 3715 left side

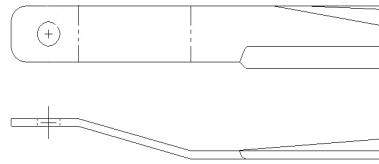

**Clockwise**

Overall Length: **24 3/4"**  
 Working Length: **22 1/4"**  
 Width: **4"**  
 Thickness: **1/2"**  
 Offset: **2"**  
 Hole Size: **1 1/2"**  
 Weight: **13.3 lbs.**

**Part Number**

**BH-462**

**Fits Models:** 6, 12, 105, 205, 266, 305, 504, 600, 5-FT, SQ60

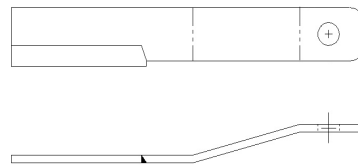

**Counter-Clockwise**

Overall Length: **24 1/2"**  
 Working Length: **22"**  
 Width: **3 1/2"**  
 Thickness: **1/2"**  
 Offset: **2"**  
 Hole Size: **1 1/2"**  
 Weight: **11.8 lbs.**

**Part Number**

**BH-463**

**Fits Models:** 206, 306, 307, 6-FT, SQ720  
 (Can use BH-7556 for an up-lift alternative blade.)

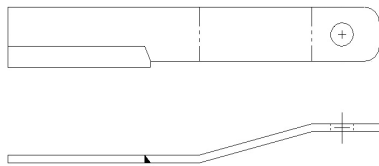

**Counter-Clockwise**

Overall Length: **27 1/2"**  
 Working Length: **25"**  
 Width: **3 1/2"**  
 Thickness: **1/2"**  
 Offset: **2"**  
 Hole Size: **1 1/2"**  
 Weight: **13 lbs.**

**Part Number**

**BH-464**

**Fits Models:** 207, 257, 307, 7-FT

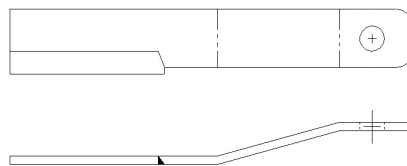

**Counter-Clockwise**

Overall Length: **30 3/4"**  
 Working Length: **28 1/4"**  
 Width: **3 1/2"**  
 Thickness: **1/2"**  
 Offset: **2"**  
 Hole Size: **1 1/2"**  
 Weight: **14 lbs.**

**Part Number**

**BH-60528**

**Fits Models:** 220 (20' cut)  
 (2 per machine)

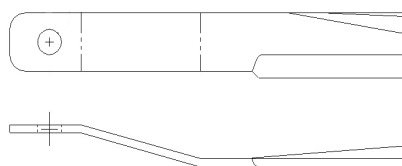

**Clockwise**

Overall Length: **30 1/4"**  
 Working Length: **28 1/4"**  
 Width: **4"**  
 Thickness: **1/2"**  
 Offset: **2"**  
 Hole Size: **1 1/2"**  
 Weight: **17 lbs.**

Hvy.-Duty Rotary Cutter Parts

**O.E.M. Style Blades**

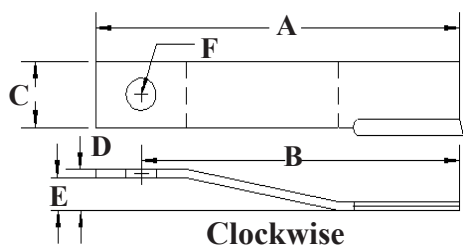

**Clockwise**

Overall Length: **A**  
 Working Length: **B**  
 Width: **C**  
 Thickness: **D**  
 Offset: **E**  
 Hole Size: **F**

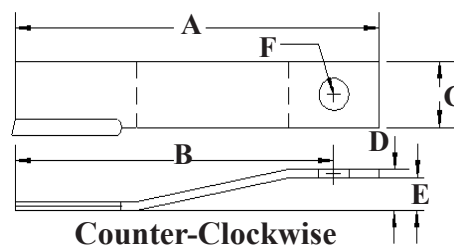

**Counter-Clockwise**

**Part Number**

**BH-63968**

**Fits Models:** SM60

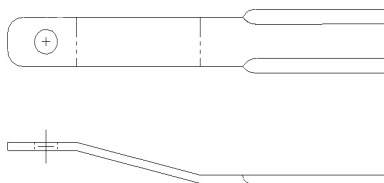

**Non-Directional**

Overall Length: **24 1/2"**  
 Working Length: **22"**  
 Width: **3"**  
 Thickness: **1/2"**  
 Offset: **2"**  
 Hole Size: **1 1/2"**  
 Weight: **9.8 lbs.**

**Part Number**

**BH-7278**

**Fits Models:** 406

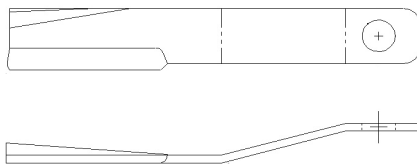

**Counter-Clockwise**

Overall Length: **27 3/4"**  
 Working Length: **25 1/4"**  
 Width: **5"**  
 Thickness: **5/8"**  
 Offset: **2"**  
 Hole Size: **2"**  
 Weight: **22.6 lbs.**

**Part Number**

**BH-7555**

**Fits Models:** 126 left & offset, 310 right, 315 right, 1126 left & offset, 1226 left, 1310 right, 1315 right, 6 uplift, 12 uplift, 105 uplift, 205 uplift, 266 uplift, 305 uplift, 502 uplift, 600 uplift, 3715 right, 2315 right, 2615 right, 2415 right

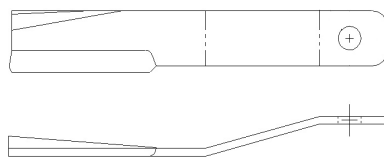

**Counter-Clockwise**

Overall Length: **24 3/4"**  
 Working Length: **22 1/4"**  
 Width: **4"**  
 Thickness: **1/2"**  
 Offset: **2"**  
 Hole Size: **1 1/2"**  
 Weight: **13.9 lbs.**

**Part Number**

**BH-7556**

**Fits Models:** 310 center, 315 center, 1310 center, 1315 center, 206 uplift, 306 uplift, SQ720, 3715 center, 2315 center, 2615 center, 2415 center, 3615 center

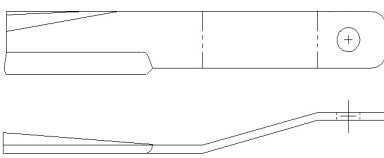

**Counter-Clockwise**

Overall Length: **27 3/4"**  
 Working Length: **25 1/4"**  
 Width: **4"**  
 Thickness: **1/2"**  
 Offset: **2"**  
 Hole Size: **1 1/2"**  
 Weight: **15 lbs.**

**Part Number**

**BH-7557**

**Fits Models:** 220 (20' cut), 207, 257, 307

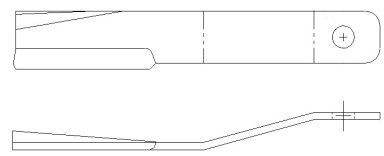

**Counter-Clockwise**

Overall Length: **30 3/4"**  
 Working Length: **28 1/4"**  
 Width: **4"**  
 Thickness: **1/2"**  
 Offset: **2"**  
 Hole Size: **1 1/2"**  
 Weight: **17 lbs.**

Hyv.-Duty Rotary Cutter Parts

Blade bolts and related mounting hardware can be found on pages 45-47.

**O.E.M. Style Blades**

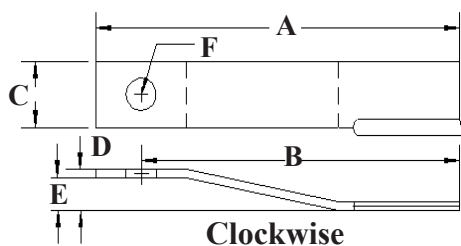

Overall Length: **A**  
 Working Length: **B**  
 Width: **C**  
 Thickness: **D**  
 Offset: **E**  
 Hole Size: **F**

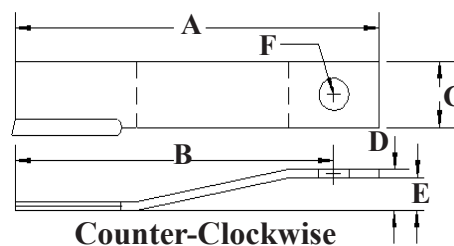

Hvy.-Duty Rotary Cutter Parts

**Part Number**

**BH-7828**

**Fits Models:** 109 left side & offset, 160 right side & center, 166 right side & center, 1109 left side & offset, 1166 right side & center, 1209 left side, 1600 right side & center

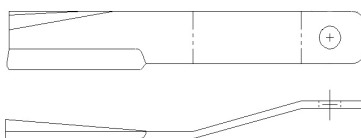

**Counter-Clockwise**

Overall Length: **19 1/4"**  
 Working Length: **16 3/4"**  
 Width: **4"**  
 Thickness: **1/2"**  
 Offset: **2"**  
 Hole Size: **1 1/2"**  
 Weight: **10.5lbs.**

**Part Number**

**BH-7829**

**Fits Models:** 109 right side, 160 left side, 166 left side, 1109 right side, 1166 left side, 1209 right side, 1600 left side

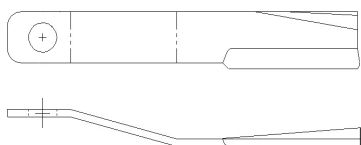

**Clockwise**

Overall Length: **19 1/4"**  
 Working Length: **16 3/4"**  
 Width: **4"**  
 Thickness: **1/2"**  
 Offset: **2"**  
 Hole Size: **1 1/2"**  
 Weight: **10.5 lbs.**

**Part Number**

**BH-90014**

**Fits Models:** 316S, 1312R, 3126 (2 used), 3126R, 3210, 13126S, updraft (Old #78494)

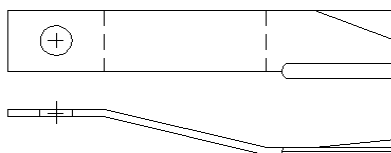

**Clockwise**

Overall Length: **24"**  
 Working Length: **21 1/2"**  
 Width: **4"**  
 Thickness: **1/2"**  
 Offset: **2"**  
 Hole Size: **1 1/2"**  
 Weight: **13.6 lbs.**

**Part Number**

**BH-90015**

**Fits Models:** 3126-0 (4 used), 3126 (2 used), 3126R & offset, 3126S & offset, 3210, 13126R, 13126S, updraft (Old #78495)

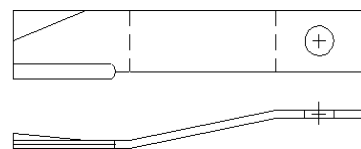

**Counter-Clockwise**

Overall Length: **24"**  
 Working Length: **21 1/2"**  
 Width: **4"**  
 Thickness: **1/2"**  
 Offset: **2"**  
 Hole Size: **1 1/2"**  
 Weight: **13.6 lbs.**



**Visit us on the web!**  
[www.flailmaster.com](http://www.flailmaster.com)

Blade bolts and related mounting hardware can be found on pages 45-47.

**O.E.M. Style Blades**

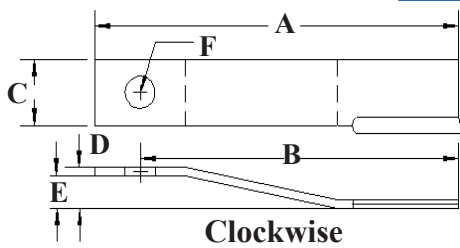

Overall Length: **A**  
 Working Length: **B**  
 Width: **C**  
 Thickness: **D**  
 Offset: **E**  
 Hole Size: **F**

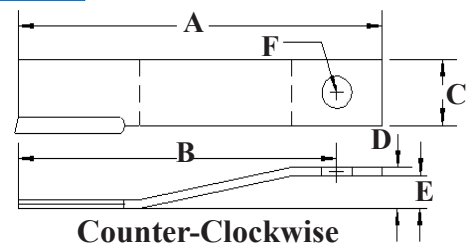

**Counter-Clockwise**

**Part Number**

**H-C49**

**Fits Models:** T160, T160LT, T160LTO, T166LT, T166LTO, T168, T172, T172LTO, H-CO except 66" & 72" w/Round Blade Holder

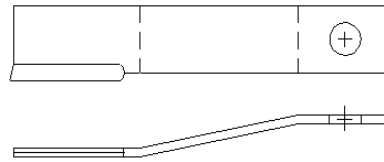

**Counter-Clockwise**

Overall Length: **23"**  
 Working Length: **20 1/2"**  
 Width: **3"**  
 Thickness: **1/2"**  
 Offset: **3"**  
 Hole Size: **1 1/2"**  
 Weight: **9.3 lbs.**

**Diamond and John Deere Blades Not Listed  
 Please call for Availability**

**Land Pride®**

**Part Number**

**LP-820-112C**

**Fits Models:** RCF(M)45180 (2 used on LH Deck), RCR3510, RCR(M)3515, Parallel Arm Cutter

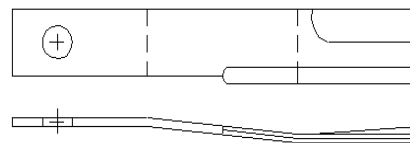

**Clockwise**

Overall Length: **25"**  
 Working Length: **23 1/4"**  
 Width: **4"**  
 Thickness: **1/2"**  
 Offset: **2 1/2"**  
 Hole Size: **1 1/2"**  
 Weight: **12.9 lbs.**

**Part Number**

**LP-820-137C**

**Fits Models:** RCF(M)45180 (2 for RH Deck), RCR2560, RCR2572, RCR(M)3515, RCR(M)3510, RCR(M)2515, RCR(M)3596

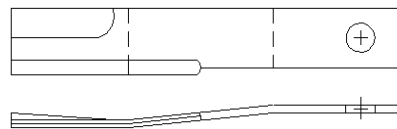

**Counter-Clockwise**

Overall Length: **25"**  
 Working Length: **23 1/4"**  
 Width: **4"**  
 Thickness: **1/2"**  
 Offset: **2 1/2"**  
 Hole Size: **1 1/2"**  
 Weight: **13.2 lbs.**

**Part Number**

**LP-820-138C**

**Fits Models:** RCR2584, RCR(M) 3515 Center

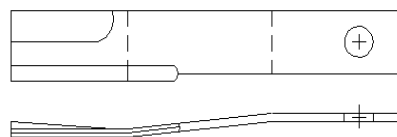

**Counter-Clockwise**

Overall Length: **31"**  
 Working Length: **28 1/2"**  
 Width: **4"**  
 Thickness: **1/2"**  
 Offset: **2 1/2"**  
 Hole Size: **1 1/2"**  
 Weight: **16.3 lbs.**

**Blade bolts and related mounting hardware can be found on pages 45-47.**



**O.E.M. Style Blades**

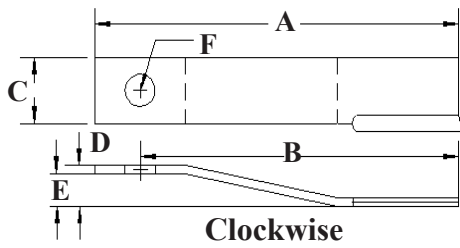

Overall Length: **A**  
 Working Length: **B**  
 Width: **C**  
 Thickness: **D**  
 Offset: **E**  
 Hole Size: **F**

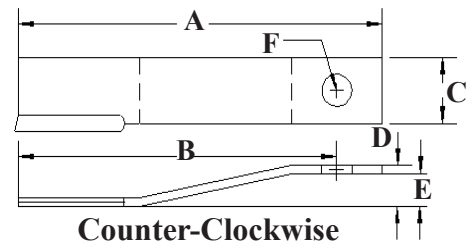

**Counter-Clockwise**

Hvy.-Duty Rotary Cutter Parts

**Part Number**  
**LP-820-168C**

**Fits Models:** RCB6015  
 (2 for Center Section), RC(M)5010,  
 RC(M)5015, RC(M)6010,  
 RC(M)6015

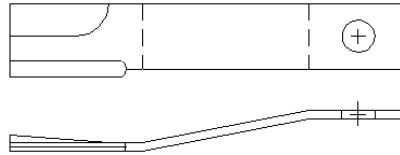

**Counter-Clockwise**

Overall Length: **29"**  
 Working Length: **26 1/4"**  
 Width: **4"**  
 Thickness: **1/2"**  
 Offset: **2 1/2"**  
 Hole Size: **1 1/2"**  
 Weight: **12 lbs.**

**Part Number**  
**LP-820-169C**

**Fits Models:** RCB6015  
 (2 for RH Section), RC(M)5010,  
 5015, 6010, 6015

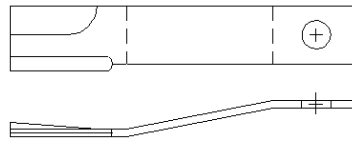

**Counter-Clockwise**

Overall Length: **23"**  
 Working Length: **20 1/2"**  
 Width: **4"**  
 Thickness: **1/2"**  
 Offset: **2 1/2"**  
 Hole Size: **1 1/2"**  
 Weight: **12.2 lbs.**

**Part Number**  
**LP-820-170C**

**Fits Models:** RCB6015 (2 for LH  
 Section), RC(M)5015, 6015 (2 for  
 LH Wing)

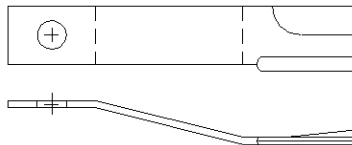

**Clockwise**

Overall Length: **23"**  
 Working Length: **20 1/4"**  
 Width: **4"**  
 Thickness: **1/2"**  
 Offset: **2 1/2"**  
 Hole Size: **1 1/2"**  
 Weight: **12.2 lbs.**

**Schulte®**

**Part Number**  
**SCH-401-026**

**Fits Models:** XH1500 Wing

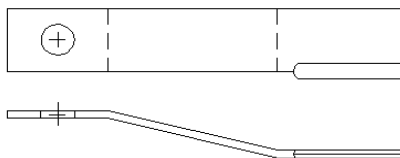

**Clockwise**

Overall Length: **24 3/4"**  
 Working Length: **22 1/4"**  
 Width: **4"**  
 Thickness: **1/2"**  
 Offset: **2 1/4"**  
 Hole Size: **1 1/2"**  
 Weight: **13.4 lbs.**

Blade bolts and related mounting hardware can be found on pages 45-47.

**O.E.M. Style Blades**

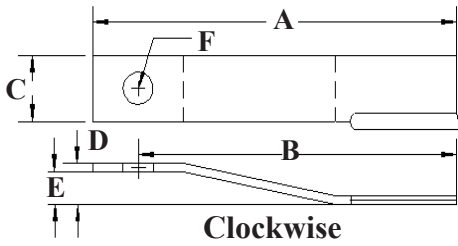

Overall Length: **A**  
 Working Length: **B**  
 Width: **C**  
 Thickness: **D**  
 Offset: **E**  
 Hole Size: **F**

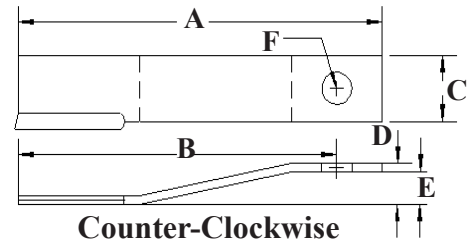

**Part Number**  
**SCH-401-027**

**Fits Models:** XH1500 Wing,  
 XH1000

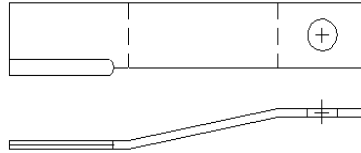

**Counter-Clockwise**

Overall Length: **24 3/4"**  
 Working Length: **22 1/4"**  
 Width: **4"**  
 Thickness: **1/2"**  
 Offset: **2 1/4"**  
 Hole Size: **1 1/2"**  
 Weight: **13.4 lbs.**

**Part Number**  
**SCH-401-028**

**Fits Models:** XH1500 Center

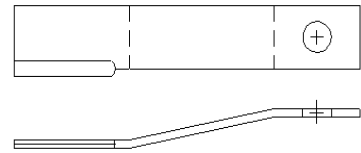

**Counter-Clockwise**

Overall Length: **28"**  
 Working Length: **25 1/2"**  
 Width: **4"**  
 Thickness: **1/2"**  
 Offset: **1 3/4"**  
 Hole Size: **1 1/2"**  
 Weight: **15.3 lbs.**

**Part Number**  
**SCH-401-032**

**Fits Models:** XH1000

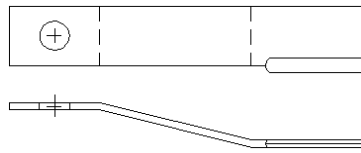

**Clockwise**

Overall Length: **28"**  
 Working Length: **25 1/2"**  
 Width: **4"**  
 Thickness: **1/2"**  
 Offset: **1 3/4"**  
 Hole Size: **1 1/2"**  
 Weight: **15.3 lbs.**

**Part Number**  
**SCH-401-046**

**Fits Models:** various highway  
 mowers

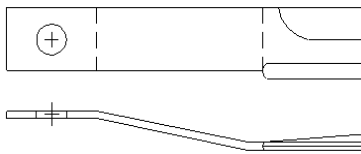

**Clockwise**

Overall Length: **25"**  
 Working Length: **22 1/4"**  
 Width: **4"**  
 Thickness: **1/2"**  
 Offset: **2"**  
 Hole Size: **1 1/2"**  
 Weight: **11.6 lbs.**

**Part Number**  
**SCH-401-047**

**Fits Models:** various highway  
 mowers

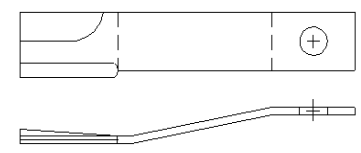

**Counter-Clockwise**

Overall Length: **25"**  
 Working Length: **22 3/4"**  
 Width: **4"**  
 Thickness: **1/2"**  
 Offset: **2"**  
 Hole Size: **1 1/2"**  
 Weight: **13.5 lbs.**

**Blade bolts and related mounting hardware can be found on pages 45-47.**

Hvy.-Duty Rotary Cutter Parts

**O.E.M. Style Blades**

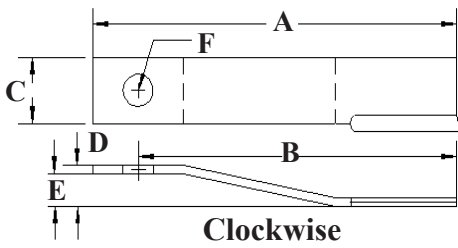

Overall Length: **A**  
 Working Length: **B**  
 Width: **C**  
 Thickness: **D**  
 Offset: **E**  
 Hole Size: **F**

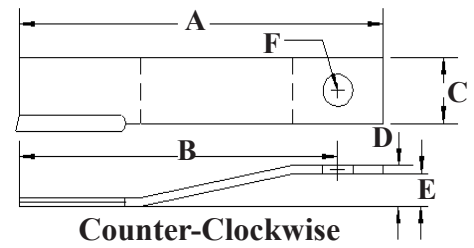

Hvy.-Duty Rotary Cutter Parts

**Part Number**  
**SCH-401-048**

**Fits Models:** various highway mowers

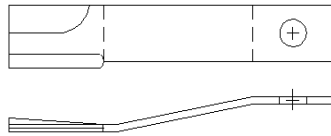

**Counter-Clockwise**

Overall Length: **29"**  
 Working Length: **25 1/2"**  
 Width: **4"**  
 Thickness: **1/2"**  
 Offset: **2"**  
 Hole Size: **1 1/2"**  
 Weight: **15.3 lbs.**

**Part Number**  
**SCH-401-052**

**Fits Models:** various highway mowers

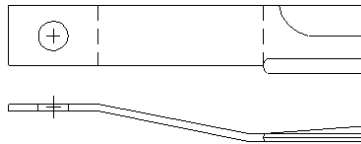

**Clockwise**

Overall Length: **28"**  
 Working Length: **25 1/8"**  
 Width: **4"**  
 Thickness: **1/2"**  
 Offset: **2 1/4"**  
 Hole Size: **1 1/2"**  
 Weight: **15.5 lbs.**



**Visit us on the web!**  
[www.flailmaster.com](http://www.flailmaster.com)

**Servis-Rhino®**

**Part Number**  
**FTK-00753841**

**Fits Models:** TW96 (2 used) updraft, SR120, SR 166, SAT8 (after S/N 10340)

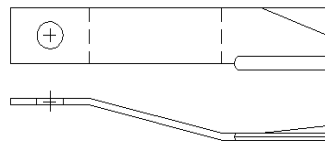

**Clockwise**

Overall Length: **20"**  
 Working Length: **17 3/8"**  
 Width: **3 1/2"**  
 Thickness: **1/2"**  
 Offset: **2"**  
 Hole Size: **1 1/2"**  
 Weight: **9.41 lbs.**

**Part Number**  
**FTK-00753842**

**Fits Models:** TW96 (2 used) updraft, SR120, SR 166, SAT8 (after S/N 10340)

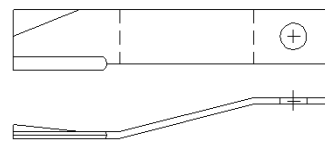

**Counter-Clockwise**

Overall Length: **20"**  
 Working Length: **17 3/8"**  
 Width: **3 1/2"**  
 Thickness: **1/2"**  
 Offset: **2"**  
 Hole Size: **1 1/2"**  
 Weight: **9.41 lbs.**

Blade bolts and related mounting hardware can be found on pages 45-47.

**O.E.M. Style Blades**

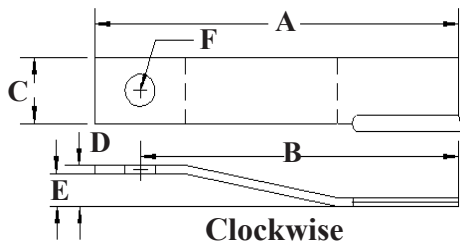

Overall Length: **A**  
 Working Length: **B**  
 Width: **C**  
 Thickness: **D**  
 Offset: **E**  
 Hole Size: **F**

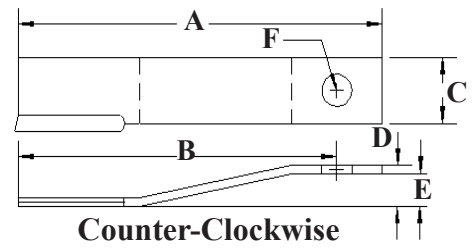

**Part Number**  
**FTK-8588**

**Fits Models:** SE15, A72, AG72-B, A415, SR72 (Serial # 10205 & up), TW72, Superflex 15III/15HD/15  
**(Set of 2 Blades)**

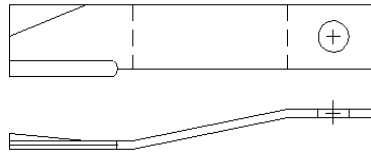

**Counter-Clockwise**

Overall Length: **26 1/4"**  
 Working Length: **24 1/4"**  
 Width: **4"**  
 Thickness: **1/2"**  
 Offset: **2 1/2"**  
 Hole Size: **1 1/2"**  
 Weight: **14.4 lbs.**

**Part Number**  
**FTK-8589**

**Fits Models:** SE15, TW60, TW120, A60, A415, AG60-B, SR60 (S/N #10145 & up), Superflex 15III/15HD/15  
**(Set of 2 Blades)**

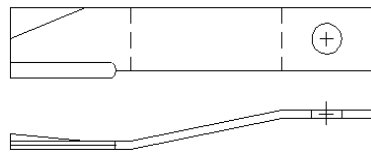

**Counter-Clockwise**

Overall Length: **20"**  
 Working Length: **18"**  
 Width: **4"**  
 Thickness: **1/2"**  
 Offset: **2"**  
 Hole Size: **1 1/2"**  
 Weight: **11 lbs.**

**Part Number**  
**FTK-8590**

**Fits Models:** SE15, right-updraft, TW120, Superflex 15III/15HD/15  
**(Set of 2 Blades)**

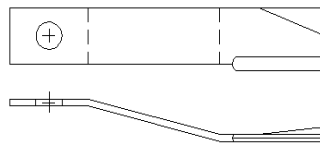

**Clockwise**

Overall Length: **20 1/4"**  
 Working Length: **18 1/4"**  
 Width: **4"**  
 Thickness: **1/2"**  
 Offset: **2"**  
 Hole Size: **1 1/2"**  
 Weight: **11 lbs.**

**Part Number**  
**S-0582010330**

**Fits Models:** CY60, Flex 15, SR15 Center, Flex 20 w/o stump jumper

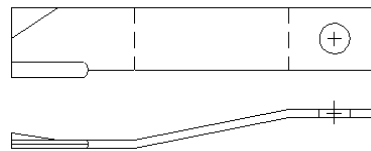

**Counter-Clockwise**

Overall Length: **27 3/4"**  
 Working Length: **25 1/2"**  
 Width: **4"**  
 Thickness: **1/2"**  
 Offset: **1 3/4"**  
 Hole Size: **1 3/8"**  
 Weight: **14.9 lbs.**

**Part Number**  
**S-0622010330**

**Fits Models:** CY60, SR15 (left wing)

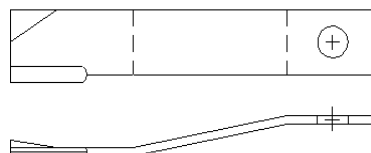

**Counter-Clockwise**

Overall Length: **24 3/4"**  
 Working Length: **22 3/4"**  
 Width: **4"**  
 Thickness: **1/2"**  
 Offset: **2 1/2"**  
 Hole Size: **1 3/8"**  
 Weight: **13.05 lbs.**

Hvy.-Duty Rotary Cutter Parts

**Blade bolts and related mounting hardware can be found on pages 45-47.**

**O.E.M. Style Blades**

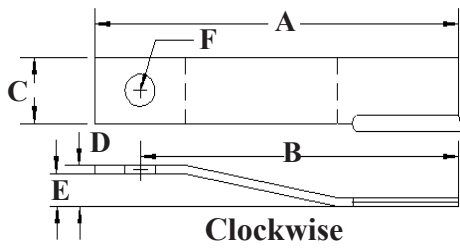

Overall Length: **A**  
 Working Length: **B**  
 Width: **C**  
 Thickness: **D**  
 Offset: **E**  
 Hole Size: **F**

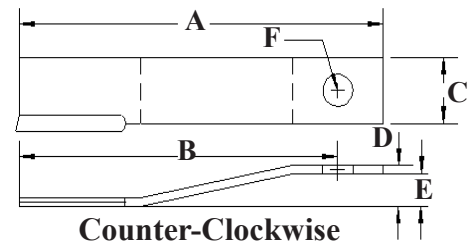

Hvy.-Duty Rotary Cutter Parts

**Part Number**  
**S-58201-3F**

**Fits Models:** Flex 15, SR15, SR15M center-updraft, CY72, FL20-BAR, SR18

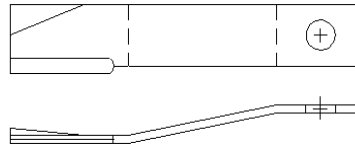

**Counter-Clockwise**

Overall Length: **27 1/2"**  
 Working Length: **25 1/4"**  
 Width: **4 1/2"**  
 Thickness: **1/2"**  
 Offset: **1 1/2"**  
 Hole Size: **1 3/8"**  
 Weight: **15 lbs.**

**Part Number**  
**S-622013F**

**Fits Models:** Flex 15, left-updraft, CY128, CY60, FS15, S128, SM66, SR15

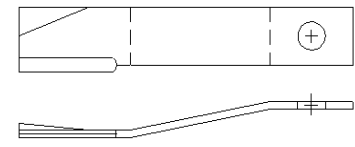

**Counter-Clockwise**

Overall Length: **24 3/4"**  
 Working Length: **22 3/4"**  
 Width: **4"**  
 Thickness: **1/2"**  
 Offset: **2"**  
 Hole Size: **1 3/8"**  
 Weight: **14 lbs.**

**Part Number**  
**S-652011RF**

**Fits Models:** Flex 15, right-updraft, CY128, FS15, S128, SR15

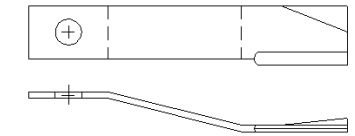

**Clockwise**

Overall Length: **24 3/4"**  
 Working Length: **22 5/8"**  
 Width: **4"**  
 Thickness: **1/2"**  
 Offset: **2"**  
 Hole Size: **1 3/8"**  
 Weight: **14 lbs.**

**Part Number**  
**S-00759338**

**Fits Models:** SR15 Magnum (2 used), left side

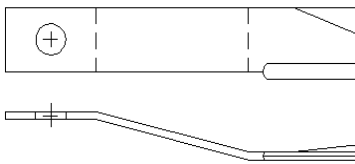

**Clockwise**

Overall Length: **22 3/16"**  
 Working Length: **20"**  
 Width: **4 1/2"**  
 Thickness: **1/2"**  
 Offset: **3"**  
 Hole Size: **1 3/8"**  
 Weight: **11.9 lbs.**

**Part Number**  
**S-00759339**

**Fits Models:** SR15 Magnum (2 used), right side

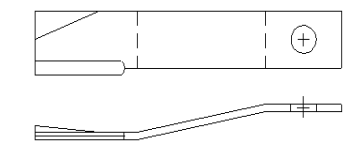

**Counter-Clockwise**

Overall Length: **22 3/16"**  
 Working Length: **20"**  
 Width: **4 1/2"**  
 Thickness: **1/2"**  
 Offset: **3"**  
 Hole Size: **1 3/8"**  
 Weight: **11.9 lbs.**

**Blade bolts and related mounting hardware can be found on pages 45-47.**



**O.E.M. Style Blades**

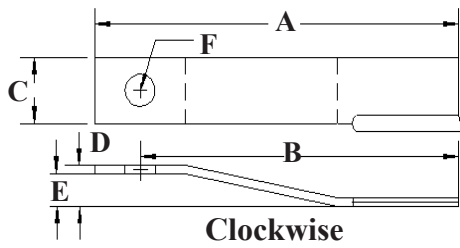

Overall Length: **A**  
 Working Length: **B**  
 Width: **C**  
 Thickness: **D**  
 Offset: **E**  
 Hole Size: **F**

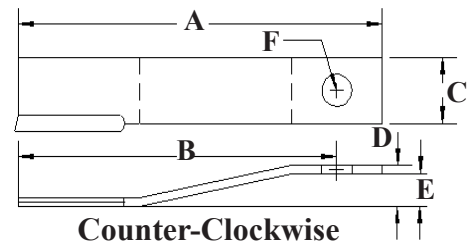

**Counter-Clockwise**

**Part Number**

**TM-06521000**

**Fits Models:**

50" rotary brush cutters  
 (must use blade bolt TM-06538000)

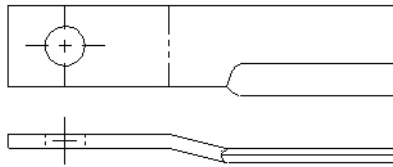

**Clockwise**

Overall Length: 17"  
 Working Length: 14 1/2"  
 Width: 5"  
 Thickness: 5/8"  
 Offset: 5/8"  
 Hole Size: 1 3/4"  
 Weight: 14.5 lbs.

**Part Number**

**TM-21251**

**Fits Models:** 72" rotary brush cutters  
 (has 1.5" mounting hole)

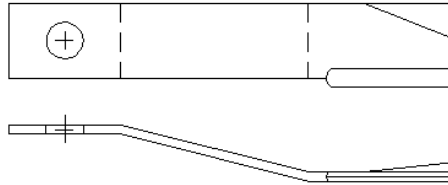

**Clockwise**

Overall Length: 26"  
 Working Length: 24 1/4"  
 Width: 4"  
 Thickness: 1/2"  
 Offset: 2"  
 Hole Size: 1 1/2"  
 Weight: 14.2 lbs.

**Fits Models:** Sabertooth®

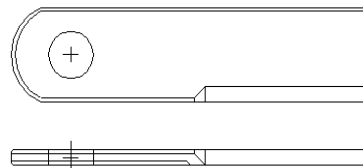

**Clockwise**

Overall Length: 18 1/4"  
 Working Length: 15 1/4"  
 Width: 6"  
 Thickness: 3/4"  
 Offset: none  
 Hole Size: 2 3/8"  
 Weight: 20.5 lbs.

**Part Number**

**TM-34684**

**Fits Models:** New style 60" Side  
 combo rotary mower, standard lift  
 (must use blade bolt TM-34497)

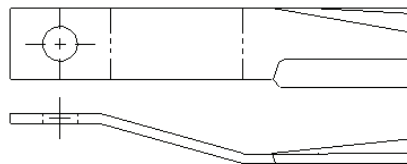

**Clockwise**

Overall Length: 20"  
 Working Length: 17 1/2"  
 Width: 4"  
 Thickness: 1/2"  
 Offset: 2"  
 Hole Size: 1 3/4"  
 Weight: 11 lbs.

**Part Number**

**TM-34685**

**Fits Models:** New style 60" Side  
 combo rotary mower, high-suction lift  
 (must use blade bolt TM-34497)

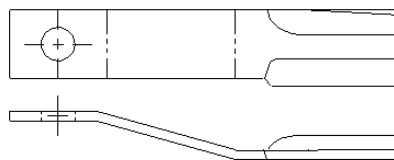

**Clockwise**

Overall Length: 20"  
 Working Length: 17 1/2"  
 Width: 4"  
 Thickness: 1/2"  
 Offset: 2"  
 Hole Size: 1 3/4"  
 Weight: 10.6 lbs.

Hvy.-Duty Rotary Cutter Parts

**O.E.M. Style Blades**

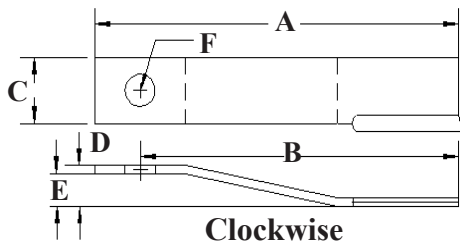

Overall Length: **A**  
 Working Length: **B**  
 Width: **C**  
 Thickness: **D**  
 Offset: **E**  
 Hole Size: **F**

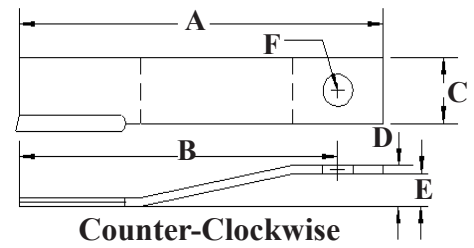

Hvy.-Duty Rotary Cutter Parts

**Part Number**  
**TM-6T1021R**

**Fits Models:**  
 60" Side, Boom, Twin Rotary,  
 & Truckat Boom mowers

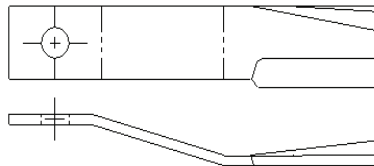

Overall Length: **20"**  
 Working Length: **17 1/2"**  
 Width: **4"**  
 Thickness: **1/2"**  
 Offset: **2"**  
 Hole Size: **1 1/2"**  
 Weight: **11 lbs.**

**Part Number**  
**TM-6T1021RS**

**Fits Models:** Suction blade  
 for 60" Side, Boom, Twin Rotary  
 & Truckat Boom mowers

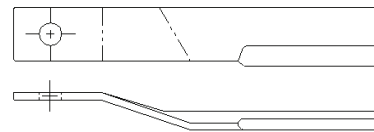

Overall Length: **20"**  
 Working Length: **17 1/2"**  
 Width: **4"**  
 Thickness: **1/2"**  
 Offset: **2"**  
 Hole Size: **1 1/2"**  
 Weight: **11 lbs.**

**Part Number**  
**TM-TB2031A**

**Fits Models:** 50" (old style)  
 Boom mower

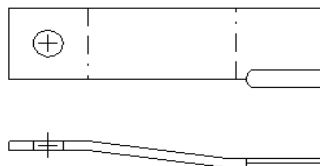

Overall Length: **17"**  
 Working Length: **14 1/2"**  
 Width: **5"**  
 Thickness: **1/2"**  
 Offset: **1"**  
 Hole Size: **1 1/2"**  
 Weight: **12 lbs.**

**Part Number**  
**TM-TB2031AHD**

**Fits Models:** Heavy-Duty blade  
 for 50" (old style) Boom mower

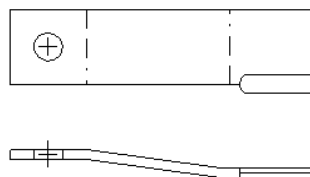

Overall Length: **17"**  
 Working Length: **14 1/2"**  
 Width: **5"**  
 Thickness: **5/8"**  
 Offset: **1"**  
 Hole Size: **1 1/2"**  
 Weight: **14.4 lbs.**

**Part Number**  
**TM-TB2031S**

**Fits Models:** Suction blade for  
 50" (old style) Boom mower

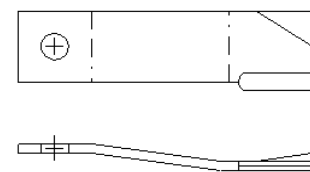

Overall Length: **17"**  
 Working Length: **14 1/2"**  
 Width: **5"**  
 Thickness: **1/2"**  
 Offset: **2"**  
 Hole Size: **1 1/2"**  
 Weight: **11.6 lbs.**

**Blade bolts and related mounting hardware can be found on pages 45-47.**

**O.E.M. Style Blades**

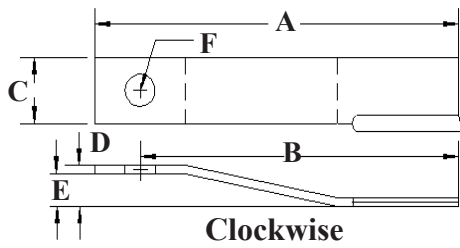

**Clockwise**

Overall Length: **A**  
 Working Length: **B**  
 Width: **C**  
 Thickness: **D**  
 Offset: **E**  
 Hole Size: **F**

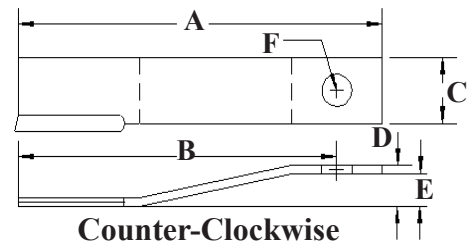

**Counter-Clockwise**

**Part Number**

**W-12892**

**Fits Models:** R105, MR105, S105-1, S105-2, P315-2, D315-3, HD315

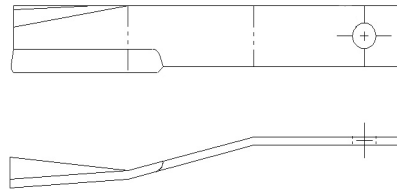

**Counter-Clockwise**

Overall Length: **24"**  
 Working Length: **21 1/2"**  
 Width: **4"**  
 Thickness: **7/16"**  
 Offset: **2 3/4"**  
 Hole Size: **1 1/2"**  
 Weight: **10.6 lbs.**

**Part Number**

**W-19160**

**Fits Models:** 4 used on 2120, 2162, 3180, 3240, 1260

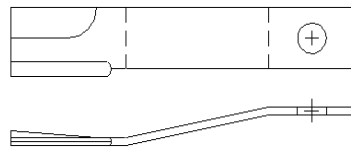

**Counter-Clockwise**

Overall Length: **25 3/8"**  
 Working Length: **22 7/8"**  
 Width: **4"**  
 Thickness: **1/2"**  
 Offset: **1 5/8"**  
 Hole Size: **1 1/2"**  
 Weight: **13.8 lbs.**

**Part Number**

**W-19161**

**Fits Models:** 2 used on 2120, 2162, 3180, 3240, 1260

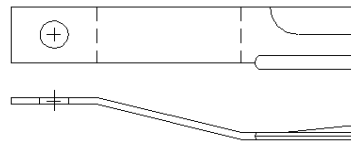

**Clockwise**

Overall Length: **25 3/8"**  
 Working Length: **22 7/8"**  
 Width: **4"**  
 Thickness: **1/2"**  
 Offset: **1 5/8"**  
 Hole Size: **1 1/2"**  
 Weight: **13.8 lbs.**

**Part Number**

**W-24771**

**Fits Models:** S105-3, P210R, D210R-3, P315-2, D315-3, HD315, 320

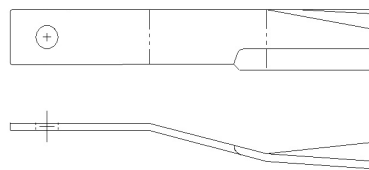

**Clockwise**

Overall Length: **24"**  
 Working Length: **21 1/2"**  
 Width: **4"**  
 Thickness: **7/16"**  
 Offset: **2 9/16"**  
 Hole Size: **1 1/2"**  
 Weight: **9.75 lbs.**

**Part Number**

**W-3900**

**Fits Models:** for 80 Series mowers



**Counter-Clockwise**

Overall Length: **18 5/8"**  
 Working Length: **17 1/8"**  
 Width: **3"**  
 Thickness: **3/8"**  
 Offset: **none**  
 Hole Size: **7/8"**  
 Weight: **5.4 lbs.**

Hvy.-Duty Rotary Cutter Parts

Blade bolts and related mounting hardware can be found on pages 45-47.

**O.E.M. Style Blades**

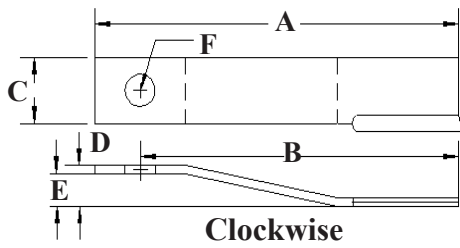

Overall Length: **A**  
 Working Length: **B**  
 Width: **C**  
 Thickness: **D**  
 Offset: **E**  
 Hole Size: **F**

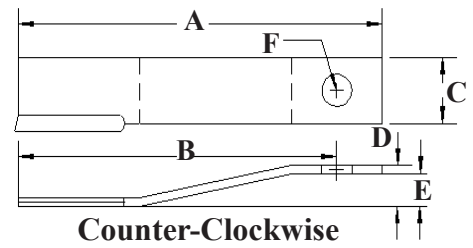

Hvy.-Duty Rotary Cutter Parts

**Part Number**  
**W-6323**

**Fits Models:** M84, S106, S106-1, S106-2, 6 and 7 foot, 213, 214, 72 Series mowers

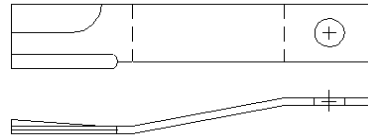

**Counter-Clockwise**

Overall Length: **30 1/4"**  
 Working Length: **27 3/4"**  
 Width: **4"**  
 Thickness: **3/8"**  
 Offset: **1 7/8"**  
 Hole Size: **1 1/2"**  
 Weight: **13.9 lbs.**

**Part Number**  
**W-6866**

**Fits Models:** M5-3, M54, 60-2, 60-3, 60-4, E60

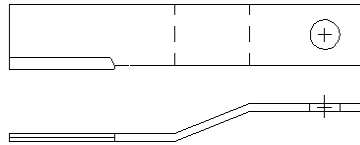

**Counter-Clockwise**

Overall Length: **22"**  
 Working Length: **20 1/2"**  
 Width: **3"**  
 Thickness: **3/8"**  
 Offset: **2"**  
 Hole Size: **1 1/2"**  
 Weight: **6.7 lbs.**

**Part Number**  
**W-8820**

**Fits Models:** HS106-1, S106-3, 211, 213, 213Q, 214, 214Q, 214R, SM214, B214QR, 315, 320, B320Q

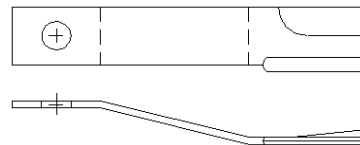

**Clockwise**

Overall Length: **30 1/4"**  
 Working Length: **28"**  
 Width: **4"**  
 Thickness: **1/2"**  
 Offset: **3"**  
 Hole Size: **1 1/2"**  
 Weight: **16 lbs.**

**Part Number**  
**W-8825**

**Fits Models:** Cadet 72 & 84, 84-1, M84, S106-1, S106-2, MD172, 184, T184, 211, 213, 213Q, 214, 214R, 214Q, SM214, 215, 315, 320, B320Q, B214QR

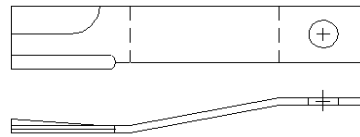

**Counter-Clockwise**

Overall Length: **30 1/4"**  
 Working Length: **28"**  
 Width: **4"**  
 Thickness: **1/2"**  
 Offset: **3"**  
 Hole Size: **1 1/2"**  
 Weight: **16 lbs.**

**Your Part Not Listed?**  
 Call 1-800-251-4020. We have access to thousands of parts not listed in this catalog.

**Mounting Hardware**

**Alamo® / Terrain King®**



**FTK-00020900**  
Slotted Nut



**FTK-00735900**  
Blade Bolt  
3 1/2" Long



**FTK-00752827**  
Blade Bolt  
3 5/8" Long



**FTK-02782900**  
Blade Bolt  
3 1/2" Long



**FTK-02964330**  
Blade Bolt  
3 3/4" Long



**FTK-8227**  
Blade Bolt  
4" Long



**FTK-8251**  
Blade Bolt  
3 5/8" Long



**FTK-00747900**  
Nut



**FTK-00748000**  
Lock Washer



**FTK-02782800**  
Roll Pin



**FTK-02964954**  
Key



**FTK-02964161**  
Blade Bushing (No Step)



**FTK-02964815**  
Blade Bushing (w/.125" Step)

**Not Able to Find Your Part?**  
Call 1-800-251-4020. We have access to thousands of parts not listed in our catalog.

**Bush Hog®**

Part #	Description
BH-2500	Kit (includes bolt, nut & lock washer)
BH-252	Nut only
BH-253	Lock Washer only
BH-7919	Blade Bolt only



Hvy.-Duty Rotary Cutter Parts

## Mounting Hardware

### Hardee

Part #	Description
H-C48Kit	Bolt Kit (includes 1-Bolt, 1-Nut,1-Washer)
H-C48	Bolt only
H-C47	Lockwasher only
H-C46	Locknut only



### Land Pride®



Part #	Description
LP-802-277CKit	Bolt Kit (includes 1 Bolt, 1 Nut, 1 Washer)
LP-802-277C	Bolt only
LP-803-170C	Nut only
LP-804-067C	Lockwasher only

Hvy.-Duty Rotary Cutter Parts

### Schulte®

Part #	Description
SCH-251-101	Bolt & Nut Kit
SCH-251-007	Bolt only
SCH-251-003	Nut only



### Servis-Rhino®



Part #	Description
S-571044KIT	Bolt & Nut Kit (1-Bolt, 1-Washer, 1-Nut)
S-571044	Bolt only (1" LH Thread)
S-571045	Washer only
S-5GL16140	Nut only (1"-14 LH Thread)



Part #	Description
S-36-107A-2ALH	Bolt (3/4" LH Thread)
S-5GL12160	Nut (3/4"-16 LH Thread)



**Mounting Hardware**

**Side-winder**

Part #	Description
SW-27724	Bolt Kit (1-Bolt, 1-Nut)
SW-15060	Bolt only (w/Cutaway Shank)
SW-15061	Nut only



**Tiger®**

Hvy.-Duty Rotary Cutter Parts

Part #	Description
TM-6T1022R	Std. Blade Bolt (shown)
TM-34497	Blade bolt for 1/2" thick blades w/ 1-3/4" mtg. hole
TM-06538000	Blade bolt for 5/8" thick blades w/ 1-3/4" mtg. hole
TM-6T1023R	Nylon Lock Nut (for use with all three)

**Sabertooth®**

Part #	Description
TM-33635	Blade Bolt only
TM-33635Key	Key only for Blade Bolt
TM-33859	Washer
TM-33860	Nut



**Woods®**

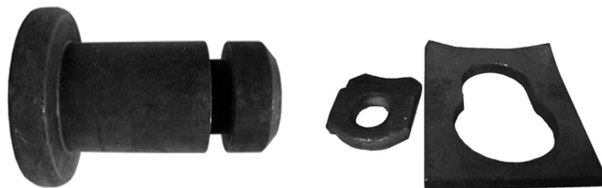

Part #	Description
W-32606	Blade Pin Kit (includes Pin & Clamp)
W-4622	Blade Pin only
W-7A6005	Clamp Kit only

Part #	Description
W-3908	Blade Pin

## Bob-Cat/Ransomes

Part #	Replaces OEM #	Description/ Requirements	Length	Center Hole	Outside Holes	Width	Thick
BC-112111-04	112111-04	(3) for 74" cut std. lift	24 15/16"	5/8"	none	2 1/2"	.250"
BC-112243-03	112243-03	(3) for 61" cut, XM Series std. lift	21"	5/8"	none	2 1/2"	.250"

## Dixie Chopper

Part #	Replaces OEM #	Description/ Requirements	Length	Center Hole	Outside Holes	Width	Thick
DC-30227-50H	30227-50H 30227-H	Hi-Lift (3) for 50" cut	17"	5/8"	none	2 1/2"	.250"
DC-30227-60	30227-60N	(3) for 60" cut	20 1/2"	5/8"	none	2 1/2"	.204"
DC-30227-60H	30227-60H	Hi-Lift (3) for 60" cut	20 1/2"	5/8"	none	2 1/2"	.250"
DC-30227-72H	30227-72H	for 72" cut, XXW2500 & 4000 Series	24"	5/8"	none	2 1/2"	.240"

## Excel/Hustler

Part #	Replaces OEM #	Description/ Requirements	Length	Center Hole	Outside Holes	Width	Thick
EX-782516	782516	(3) for 60" cut, Super Z	20 61/64"	5/8"	none	3"	.250"
EX-793794	793794	(3) for 60" cut	20.5"	5/8"	none	2 1/2"	.203"
EX-794685	794685	(3) for 60" cut, Z & Super Z XR7 & side discharge	20.5"	5/8"	none	2 1/2"	.203"
EX-797696	797696	(3) for 54" cut, XR7 Super Z & Z3	18 1/2"	5/8"	none	2 1/2"	.203"

### Why should you be using our Oregon® blades?



- Our blades are made in the U.S.A.
- Our blades have superior life because they are 20% harder
- Our blades stay sharp longer because of their heat treat
- Our blades are precision straightened for less vibration

**We stock parts not listed in our catalog.  
Call 1-800-251-4020 for prices and availability.**

\*All Part Numbers are for identification purposes only

## Exmark®

Part #	Replaces OEM #	Description/ Requirements	Length	Center Hole	Outside Holes	Width	Thick
EXM-403026	323515,403026 103-2527 103-6583	(3) for 48" cut	16 1/4"	5/8"	none	2 1/2"	.150"
EXM-613112	613112	Mulching Blade fits 60" Lazer Z	20 7/16"	5/8"	none	2 1/2"	.204"
EXM-613250MM	613250 633483 103-2530	Gator Mulcher Magnum (3) for 60" Lazer Z or Turf Ranger	20 1/2"	5/8"	none	2 1/2"	.250"
EXM-633482	633482 103-2528	(3) for 52" Turf Ranger Turf Tracer & Lazer Z	18"	5/8"	none	2 1/2"	.203"
EXM-633483	633483 103-2530	(3) for newer 60" Lazer Z or Turf Ranger	20 1/2"	5/8"	none	2 1/2"	.210"
EXM-633484	633484 103-2518 103-6582	Mulching Blade fits 52" Lazer Z	17 15/16"	5/8"	none	2 1/2"	.204"
EXM-643006	643006 103-2531	fits 72" Lazer Z	24 7/16"	5/8"	none	3"	.203"
EXM-653101	653101 103-2529	fits 44" Lazer Z	15 3/16"	5/8"	none	2 1/2"	.205"
EXM-653102	653102 103-2519	Std. Mulching Blade (3) for 44" Lazer Z	15 3/16"	5/8"	none	2 1/2"	.212"
EXM-653102M	653102 103-2519	Gator Mulching Blade (3) for 44" cut	15 1/4"	5/8"	none	2 1/2"	.203"

## Ferris

Part #	Replaces OEM #	Description/ Requirements	Length	Center Hole	Outside Holes	Width	Thick
FE-1521227	1521227 1521227S	(2) for 36" cut (3) for 52" cut	18"	5/8"	none	2 1/2"	.250"
FE-1520842	1520842	(3) for 61" Comm. Pro Cut	21"	5/8"	none	2 1/2"	.250"
FE-1520843	1520843 1520843S	(3) for 48" cut	16 1/4"	5/8"	none	2 1/2"	.250"
FE-48113	48113 48112	(3) for 72" cut	24 1/2"	5/8"	none	2 1/2"	.203"

**We stock parts not listed in our catalog.  
Call 1-800-251-4020 for prices and availability.**

\*All Part Numbers are for identification purposes only

# Blades

Your BEST Choice for Quality Mower Parts

## Grasshopper®

Part #	Replaces OEM #	Description/ Requirements	Length	Center Hole	Outside Holes	Width	Thick
GH-320231	320231	(3) for 44" cut	15"	1/2"	none	2"	.204"
GH-320236	320236	(3) for 52" cut, outer blade for 48" cut, Low-Lift	18"	1/2"	none	2"	.204"
GH-320237	320237 320239	(3) for 52" cut, Hi-Lift	18"	1/2"	none	2"	.204"
GH-320242	320242	Low Lift (3) for 61" cut	21"	1/2"	none	2 1/2"	.250"
GH-320243	320243A 320244	Heavy Duty, Hi-Lift (3) for 61" cut	21"	1/2"	none	2 1/2"	.250"
GH-320245	320243 320245	Heavy Duty, <u>Notched</u> Hi-Lift (3) for 61" cut	21"	1/2"	none	2 1/2"	.250"

## Gravely®

Part #	Replaces OEM #	Description/ Requirements	Length	Center Hole	Outside Holes	Width	Thick
GR-025124	025124 08904651 08899000	(2) for 40" cut (3) for 60" cut	20 1/2"	5/8"	none	2"	.250"
GR-03498451	014668 03498451 08899800	(3) for 40" cut fits Pro100 Series	13 7/8"	5/8"	none	2"	.204"
GR-046998	046998 08779251 08899600	(3) for 50" cut, Hi-Lift fits Pro200 & 300 Series & 34Z	17"	5/8"	none	2 1/2"	.260"
GR-08861651	11234 08861651 08899300	(3) for 50" cut fits Pro150, 200 & 300 Series	17"	5/8"	none	2"	.204"

## Great Dane

Part #	Replaces OEM #	Description/ Requirements	Length	Center Hole	Outside Holes	Width	Thick
GD-D18036	D18036	(3) for 61" cut	21"	5/8"	none	2 1/2"	.204"
GD-D18037	D18037	(2) for 36" cut (3) for 54" cut	18"	5/8"	none	2 1/2"	.204"
GD-D18086A	D18086A	(3) for 48" cut	16 1/2"	5/8"	none	2 1/2"	.203"
GD-D18406	D18406	(3) for 36" cut	12 21/32"	5/8"	none	2 1/2"	.203"

## Jacobsen

Part #	Replaces OEM #	Description/ Requirements	Length	Center Hole	Outside Holes	Width	Thick
JA-390515	JT390515	(3) for 72" cut, fits Turfcut	24 15/16"	7/16"	13/32"	2 1/2"	.250"
JA-391039	JT391039	LH Cut (4) for HR511	23"	17/32"	2 7/8"	2 1/2"	.250"
JA-391040	JT391040	RH Cut (3) for HR511	23"	17/32"	13/32"	2 1/2"	.250"

## John Deere

Part #	Replaces OEM #	Description/ Requirements	Length	Center Hole	Outside Holes	Width	Thick
JD-AM100946	AM100946 M82408 M83459	(2) for 38" cut riding mowers	19 1/2"	11/16"	none	2 1/2"	.204"
JD-AM31100	AM31100 M41967	(3) for 46" cut, fits 46", 47" & 48" lawn tractors	16"	11/16"	none	2"	.188"
JD-AM102401	AM102401 M141786 M80783 M83363	(3) for 72" cut, fits 750-1070 Series	25"	29/32"	none	2 1/2"	.302"
JD-M115495	M115495	(3) for 48" cut (new style)	16 5/8"	51/64"	none	2 1/2"	.203"
JD-M115496	M115496 M113517	(3) for 54" cut, front mount & Z trak	18 5/8"	13/16"	none	2 1/2"	.204"
JD-M119975	M119975	(3) for 72" cut, fits F925, F935, F1145 front mount	25"	29/32"	none	2 1/2"	.302"
JD-M128485	M128485 M144196	for 60" Z-Trac, 7 Iron decks	21"	29/32"	none	2 1/2"	.312"
JD-M143520	M143520 M145516	(3) for 54" cut, convertible deck	18 29/32"	51/64"	none	2 1/2"	.203"

## Kubota®

Part #	Replaces OEM #	Description/ Requirements	Length	Center Hole	Outside Holes	Width	Thick
KU-5677-34340	5677-34340 76553-34330	(3) for 72" Pro Deck, Hi-lift	24 1/2"	1 1/8"	none	2 1/2"	.250"
KU-70090GM	30708, 70090 5676-97520	(3) for 72" cut, Gator Mulcher Magnum	24 5/8"	1 1/8"	none	2 1/2"	.250"
KU-76539-34330	76539-34330 7000-00602	(3) for 60" cut, front mount	20 9/16"	1 1/8"	none	2 1/2"	.250"
KU-76540-34330	76540-34330	(3) for 60" cut, fits RC60-20 & RC60-25	20 7/16"	29/32"	none	2 1/2"	.250"
KU-76550-34330	76550-34330	(3) for 72" cut, fits RC72, Model 2900L w/ RC7229 deck	24 1/2"	59/64"	none	2 1/2"	.312"
KU-76553-34330	76553-34330 70000-25002	(3) for 72" cut, std. lift	24 1/2"	1 1/8"	none	2 1/2"	.25"

Riding & Walk Behind Parts

**Gator Mulcher™ Blades available for many manufacturers/models.  
Call 1-800-251-4020 for prices and availability.**



**Benefits:**

- Pulls clippings down and discharges them from deck. Aids in re-cutting of clippings for quicker decomposing.
- Moves more air with less horsepower.
- Produces fine clippings. Promotes clipping flow to center of the deck.
- Longer wear. Holds cutting edge longer.
- Provides more efficient recutting of clippings.

## Scag

Part #	Replaces OEM #	Description/ Requirements	Length	Center Hole	Outside Holes	Width	Thick
SC-A48108	A48108 481707 482878	(2) for 36" cut, (3) for 52" cut, fits Tiger Cub, Wildcat, Turf Tiger	18"	5/8"	none	2 1/2"	.204"
SC-A48110	A48110 481706	(2) for 32" cut (3) for 48" cut	16 1/2"	5/8"	none	2 1/2"	.204"
SC-A48111	A48111 481708	(3) for 61" cut	21"	5/8"	none	2 1/2"	.204"
SC-A48112	A48112 48113 481709	(3) for 72" cut	24 1/2"	5/8"	none	2 1/2"	.204"
SC-A48184	A48184 481710	(2) for 32" cut, Hi-Lift (3) for 48" cut, Hi-Lift	16 1/2"	5/8"	none	3"	.204"
SC-A48185	A48185 481711	(2) for 36" cut, Hi-Lift (3) for 52" cut, Hi-Lift	18"	5/8"	none	3"	.204"
SC-A48304	A48304 481712	Super Hi-Lift (3) for 61" cut	21"	5/8"	none	3"	.203"

## Toro®

Part #	Replaces OEM #	Description/ Requirements	Length	Center Hole	Outside Holes	Width	Thick
TO-23-2410	23-2410	Hi-Lift, LH Turn (3) for 72" cut Groundmaster	25"	3/4"	none	2 1/2"	.250"
TO-29-5530	29-5530	(3) for 72" cut, LH Turn	24 15/16"	3/4"	none	2 1/2"	.240"
TO-44-5480	44-5480 27-0990	(2) for 36" cut, Hi-Lift (3) for 52" cut, Hi-Lift Wide area walk behind	18"	1/2"	none	2 1/2"	.188"
TO-44-6250	44-6250 44-6250-03	(3) for 62" cut Groundsmaster	21 1/2"	1/2"	none	2 1/2"	.203"
TO-56-2390	56-2390	(2) for 36" cut, (3) for 52" cut, fits walk behind & Z Master	18"	1/2"	none	2 1/2"	.194"
TO-69-6920	69-6920	(11) for 16' cut Groundmaster 580D model	20"	5/8"	none	2 1/2"	.250"
TO-85-6040	85-6040	(3) for 72" cut, Recycler, Groundmaster	25 7/32"	1/2"	none	2 1/2"	.250"
TO-86-0010	86-0010	(7) for 455D model	19"	1/2"	none	2 1/2"	.250"
TO-92-5608	92-5608	(3) for 62" cut, Recycler	21 11/16"	1/2"	none	2 1/2"	.250"

### Why should you be using our Oregon® blades?



- Our blades are made in the U.S.A.
- Our blades have superior life because they are 20% harder
- Our blades stay sharp longer because of their heat treat
- Our blades are precision straightened for less vibration



## Walker

Part #	Replaces OEM #	Description/ Requirements	Length	Center Hole	Outside Holes	Width	Thick
WA-5705-3	5705-3	RH Cut (1) for 42" cut rear discharge (3) for 54" cut	22"	5/8"	3/16"	2 3/4"	.164"
WA-5705-4	5705-4	LH Cut (1) for 42" cut rear discharge (3) for 54" cut	22"	5/8"	3/16"	2 3/4"	.164"
WA-7705-1	7705-1	Hi-Lift, RH Cut (1) for 48" cut rear discharge	25"	5/8"	3/16"	2 3/4"	.164"
WA-7705-2	7705-2	Hi-Lift, LH Cut (1) for 48" cut rear discharge	25"	5/8"	3/16"	2 3/4"	.164"

## Woods®

Part #	Replaces OEM #	Description/ Requirements	Length	Center Hole	Outside Holes	Width	Thick
WO-24590	24590	(6) for 44" cut	11 1/2"	7/8"	none	2"	.203"
WO-31306	13404 31306	LH Cut, (3) for 72" cut (L306, RM306, RM600)	24 7/16"	1"	none	2 1/2"	.203"
WO-31359	23825 31359	LH Cut, (3) for 60" cut (RM59)	20 3/16"	5/8"	none	2"	.204"
WO-6950	6950	Medium Lift, (3) for 60" cut	20 3/16"	5/8"	none	2"	.204"
WO-70134	70134	(3) for 61" cut	21"	1/2"	none	2 1/2"	.250"

## Wright

Part #	Replaces OEM #	Description/ Requirements	Length	Center Hole	Outside Holes	Width	Thick
WR-71440001	71440001	(2) for 36" cut (3) for 52" cut	18"	5/8"	none	2 1/2"	.204"
WR-71440001M	71440001	(2) for 36" cut, (3) for 52" cut, Gator Mulcher Magnum	18"	5/8"	none	2 1/2"	.203"
WR-71440002	71440002	(2) for 32" cut (3) for 48" cut	16 1/2"	5/8"	none	2 1/2"	.204"
WR-71440003	71440003	(3) for 61" cut	21"	5/8"	none	2 1/2"	.204"

## Yazoo/Kees

Part #	Replaces OEM #	Description/ Requirements	Length	Center Hole	Outside Holes	Width	Thick
YZ-206-660	206-660	(3) for 60" cut	20 3/4"	3/4" x 1 1/4"	none	2 1/4"	.250"
YZ-206-970	206-970	(3) for 61" cut	21 3/8"	5/8"	none	2 1/2"	.203"

## Choose a Standard Line That's Right for You.

Size	Recommended Usage
<b>.080"</b>	Homeowner, 20 to 24.5cc, curved shaft models with manual and automatic feed heads.
<b>.095"</b>	Homeowner and commercial, 25 to 39.5cc, curved and straight shaft models with automatic and manual feed heads.
<b>.105"</b>	Commercial, 40cc and higher, straight shaft models with manual feed heads.
<b>.130"</b>	Commercial, 40cc and higher, straight shaft models with a fixed line head; also for use with high-wheel, walk behind trimmers.
<b>.155"</b>	Commercial, 40cc and higher, straight shaft models with a fixed line head; also for use with high-wheel, walk behind trimmers, 5 HP and larger.

Shape	Benefits	Recommended Application
<b>Round</b>	-High resistance to line welding. -Fray resistant. -More aerodynamic.	All types of trimmer heads.
<b>Square</b>	-More mass for longer wear. -4 edges cut cleaner and faster. -Fast and clean cutting to reduce browning of grass tips. -Fray resistant.	Manual and semi-automatic heads.
<b>Hexagon</b>	-25% more mass than round line. -No flat surfaces reduces line welding. -Fast and clean cutting to reduce browning of grass tips. -Fray resistant.	All types of trimmer heads.

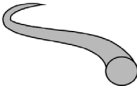
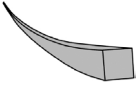
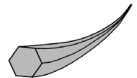
Style	Size	1 lb. Donuts	
		Part Number	
<b>Round Line</b> 	.080"	<b>TL-R080-1</b>	(405')
	.095"	<b>TL-R095-1</b>	(285')
	.105"	<b>TL-R105-1</b>	(235')
	.130"	<b>TL-R130-1</b>	(155')
Style	Size	1 lb. Donuts	
		Part Number	
<b>Square Line</b> 	.080"	<b>TL-S080-1</b>	(327')
	.095"	<b>TL-S095-1</b>	(227')
	.105"	<b>TL-S105-1</b>	(179')
	.130"	<b>TL-S130-1</b>	(120')
Style	Size	1 lb. Donuts	
		Part Number	
<b>Hex Line</b> 	.080"	<b>TL-H080-1</b>	(385')
	.095"	<b>TL-H095-1</b>	(275')
	.105"	<b>TL-H105-1</b>	(225')
	.130"	<b>TL-H130-1</b>	(145')

3 lb. Spools	
Part Number	
<b>TL-R080-3</b>	(1,215')
<b>TL-R095-3</b>	(855')
<b>TL-R105-3</b>	(705')
<b>TL-R130-3</b>	(465')
3 lb. Spools	
Part Number	
<b>TL-S080-3</b>	(980')
<b>TL-S095-3</b>	(681')
<b>TL-S105-3</b>	(538')
<b>TL-S130-3</b>	(360')
3 lb. Spools	
Part Number	
<b>TL-H080-3</b>	(1,155')
<b>TL-H095-3</b>	(825')
<b>TL-H105-3</b>	(675')
<b>TL-H130-3</b>	(435')

5 lb. Spools	
Part Number	
<b>TL-R080-5</b>	(2,025')
<b>TL-R095-5</b>	(1,425')
<b>TL-R105-5</b>	(1,175')
<b>TL-R130-5</b>	(775')
5 lb. Spools	
Part Number	
<b>TL-S080-5</b>	(1,633')
<b>TL-S095-5</b>	(1,134')
<b>TL-S105-5</b>	(896')
<b>TL-S130-5</b>	(600')
5 lb. Spools	
Part Number	
<b>TL-H080-5</b>	(2,025')
<b>TL-H095-5</b>	(1,375')
<b>TL-H105-5</b>	(1,125')
<b>TL-H130-5</b>	(725')

# Choose a Specialty Line That's Right for You.



## MAGNUM GATORLINE™

- Dual polymer re-inforced with Aramid Fibers
- Outer layer prevents welding.
- High strength inner core resists breaking.
- Long life, excellent strength.

Style	Size	1 lb. Donuts
		Part Number
Round Magnum 	.095"	TL-RM095-1 (289')
	.105"	TL-RM105-1 (228')
	.130"	TL-RM130-1 (153')
	.155"	TL-RM155-1 (107')

3 lb. Spools
Part Number
TL-RM095-3 (867')
TL-RM105-3 (685')
TL-RM130-3 (459')
TL-RM155-3 (320')

5 lb. Spools
Part Number
TL-RM095-5 (1,445')
TL-RM105-5 (1,142')
TL-RM130-5 (764')
TL-RM155-5 (533')

Style	Size	1 lb. Donuts
		Part Number
Square Magnum 	.095"	TL-SM095-1 (227')
	.105"	TL-SM105-1 (179')
	.130"	TL-SM130-1 (120')
	.155"	TL-SM155-1 (84')

3 lb. Spools
Part Number
TL-SM095-3 (681')
TL-SM105-3 (538')
TL-SM130-3 (360')
TL-SM155-3 (251')

5 lb. Spools
Part Number
TL-SM095-5 (1,134')
TL-SM105-5 (896')
TL-SM130-5 (600')
TL-SM155-5 (419')

Style	Size	1 lb. Donuts
		Part Number
SuperTwist Magnum 	.095"	TL-TM095-1 (280')
	.118"	TL-TM118-1 (180')
	.130"	TL-TM130-1 (150')

3 lb. Spools
Part Number
TL-TM095-3 (867')
TL-TM118-3 (639')
TL-TM130-3 (459')

5 lb. Spools
Part Number
TL-TM095-5 (1,430')
TL-TM118-5 (915')
TL-TM130-5 (750')

Try the new SuperTwist™ Magnum for improved cutting with less noise.

### Benefits of the SuperTwist™ Magnum Line

- Reduction in noise level of 15dB compared with traditional round nylon lines •
  - Improved cutting efficiency •
  - Reduced vibration •
  - Less resistance, reducing engine drag •

FLAIL-MASTER  
P.O. Box 1558  
Murfreesboro, TN 37133-1558

Return Service Requested

## Order Factory Direct

Phone: (615) 848-1813 Toll Free: (800) 251-4020

[info@flailmaster.com](mailto:info@flailmaster.com)

[www.flailmaster.com](http://www.flailmaster.com)

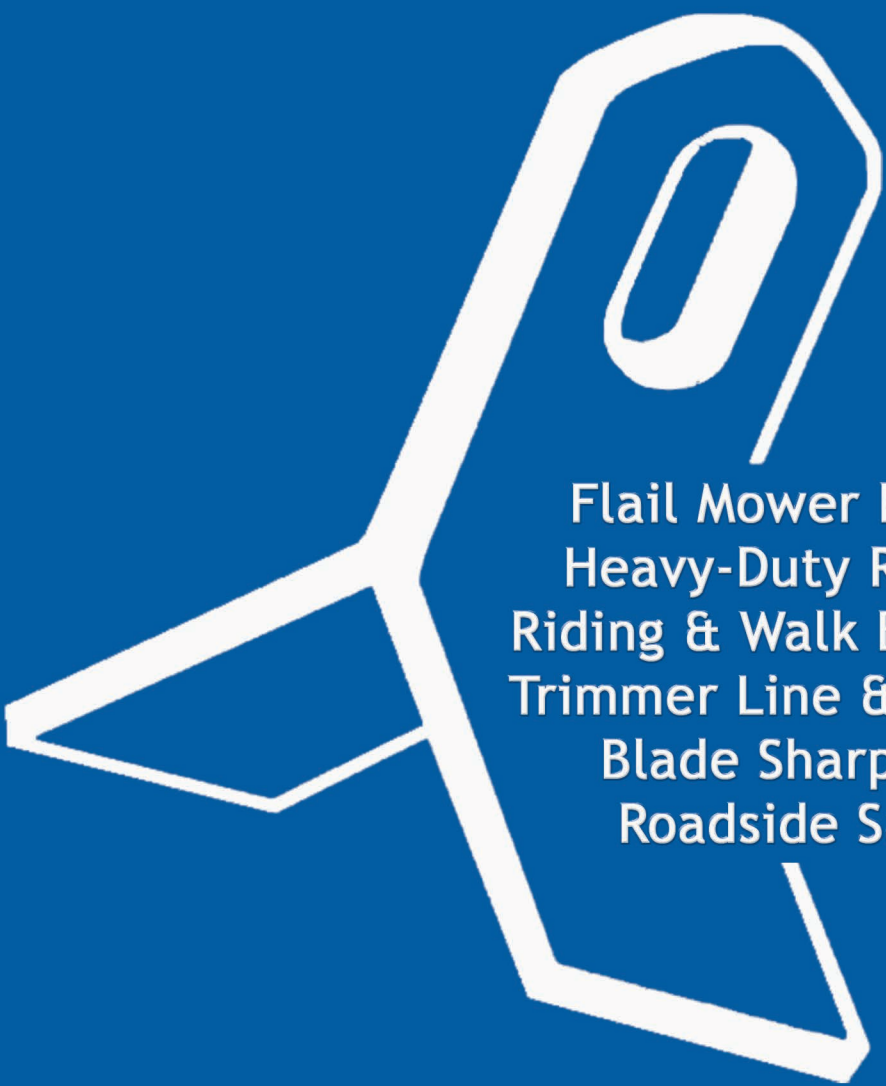

Flail Mower Replacement Parts  
Heavy-Duty Rotary Cutter Parts  
Riding & Walk Behind Mower Blades  
Trimmer Line & Mowing Accessories  
Blade Sharpening Equipment  
Roadside Safety Equipment